



🏠 **Melbourn Parish Council**  
Melbourn Community Hub  
30 High Street  
Melbourn  
SG8 6DZ

👤 Abi Williams, Clerk  
👤 Alex Coxall, Deputy Clerk  
✉ parishclerk@melbournparishcouncil.gov.uk  
☎ 01763 263303, ext 3  
🌐 melbournparishcouncil.gov.uk

---

**MELBOURN PARISH COUNCIL - PLANNING COMMITTEE**  
(District of South Cambridgeshire)

**A meeting of the Planning Committee** held on Monday 10 March 2025 at 19:30  
in the Austen Room, Community Hub, 30 High Street, Melbourn SG8 6DZ

**Present:** Cllrs Alexander, Barnes, Clark, Kilmurray (Chair), Wilson

**Absent:**

**In attendance:** Abi Williams (Parish Clerk)

**PLANNING COMMITTEE: MINUTES**

*Meeting started 19:31*

**PL103/25 To receive and approve apologies for absence**

Apologies received from Cllr Hart with acceptable reasons given.  
It was RESOLVED to accept apologies of absence from Cllr Hart.  
Proposed by Cllr Clark, seconded by Cllr Barnes. All in favour.

**PL104/25 To receive any Declarations of Interest and Dispensations**

- a) To receive declarations of interest from councillors on items on the agenda
- b) To receive written requests for dispensations for disclosable pecuniary interests (if any)
- c) To grant any requests for dispensation as appropriate

None received.

**PL105/25 To approve the minutes of the Planning Committee Meeting on 10 February 2025**

It was RESOLVED to approve the minutes of the Planning Committee Meeting held on 10 February 2025 as an accurate record.  
Proposed by Cllr Wilson, seconded by Cllr Barnes. All in favour.

**PL106/25 To report back on the minutes of the Planning Committee Meetings on 10 February 2025**

Nothing to report.

**PL107/25 Public Participation: (For up to 15 minutes members of the public may contribute their views and comments and questions to the Planning Committee – 3 minutes per item)**

No members of the public were present.

**PL108/25 Decision Notices:** To receive any decision notices issued since last meeting.

- a) [25/0006/TTCA](#) | **Proposal:** T.1 Robinia - fell to ground level due to decay in the lower stem. Bark is falling from the trees and is exposing rot. | **Site address:** 91 High Street Melbourn Cambridgeshire SG8 6AA | *MPC Comment: No objection*  
**Decision:** No objection (6 February 2025)  
The decision was noted.
- b) [24/04687/HFUL](#) | **Proposal:** Single storey rear extension. | **Site address:** 3 Clover Way Melbourn Cambridgeshire SG8 6FW | *MPC Comment: Support no comment.*  
**Decision:** Application permitted (7 February 2025)  
The decision was noted.
- c) [24/03291/CONDA](#) | **Proposal:** Submission of details required by conditions 3 (written scheme of investigation), 4 (arboricultural method statement and tree protection strategy), 6 (construction environmental management plan), 11 (contamination), 14 (traffic management plan) and 23 (water efficiency specification) of planning permission 24/03291/S73 | **Site address:** 4 Station Road Melbourn Cambridgeshire SG8 6DX | *MPC Comment: No comment*

Signed..... Date.....

**Decision:** Split decision (13 February 2025)

The decision was noted.

- d) [24/04648/FUL](#) | **Proposal:** Erection of a timber fence. | **Site address:** Hillside Farm Newmarket Road Melbourn Cambridgeshire SG8 7LZ | *MPC Comment: It was RESOLVED to object inline with concerns as raised by Highways (Concerns that the current proposal does not provide adequate inter-visibility between the users of the property access and the existing public highway for the safety and convenience of users of the highway and for access).*  
**Decision:** Application permitted (10 February 2025)  
The decision was noted.
- e) [25/00025/PRIOR](#) | **Proposal:** Erection of a grain store for the storage and separation of various crops. | **Site address:** Land Adjacent To Garden Centre Cambridge Road Melbourn Cambridgeshire SG8 6RB | *MPC Comment: No comment*  
**Decision:** Prior approval refused (10 February 2025)  
The decision was noted.
- f) [25/0035/TTCA](#) | **Proposal:** 1 Silver birch - thin, reducing inner canopy and branches growing towards nearby windows by 30% overall | **Site address:** 24 Mortlock Street Melbourn Cambridgeshire SG8 6DB | *MPC Comment: No objection*  
**Decision:** No objection (14 February 2025)  
The decision was noted.
- g) APPLICATION WITHDRAWN: [24/03015/FUL](#) | **Proposal:** Conversion of existing Double Garage into Accommodation. | **Site address:** 8 Water Lane Melbourn Cambridgeshire SG8 6AY |  
The decision was noted.
- h) [25/0057/TTCA](#) | **Proposal:** T1 - Prunus - Reduce spread on all sides by up to 2m and shape into remainder of canopy, retaining height. T2 - Beech - Reduce height and spread on all sides by up to 2.5m, down to previous reduction points. | **Site address:** 9 Drury Lane Melbourn Cambridgeshire SG8 6EP | *MPC Comment: No comment*  
**Decision:** No objection (17 February 2025)  
The decision was noted.
- i) [24/04616/FUL](#) | **Proposal:** Change of use of part of ground floor to the rear of the building to exercise studio (Use Class E(d)), use of existing exercise studio as a cafe (Use Class E(b)). | **Site address:** 28 Station Road Melbourn Cambridgeshire SG8 6DX | *MPC Comment: Support no comment*  
**Decision:** Application permitted (24 February 2025)  
The decision was noted.

**PL109/25 To note the following applications for tree work:**

- a) [25/0147/TTCA](#) | **Proposal:** T1,T2,T3 & T4 - Ash - Fell to ground level. | **Site address:** 44 High Street Melbourn Cambridgeshire | (Deadline to comment 4 Mar 2025) *No objection from email.*  
No objection.
- b) [25/0137/TTCA](#) | **Proposal:** T1 - Shrub – Remove, T2 - Shrub Reduce by 1 metre, T4 Box Elder – Remove, T5 Mahonia - Reduce by 1.5metres, T6 Holly - Reduce by 1 metre | **Site address:** 2 Meadow Way Melbourn Cambridgeshire | (Deadline to comment 5 Mar 2025) *No objection from email.*  
No objection.
- c) [25/0201/TTCA](#) | **Proposal:** T.1 Beech - Crown reduce the height by 3M and lateral branches by 2.5M (back to suitable twig growth). | **Site address:** 66 High Street Melbourn Cambridgeshire SG8 6AJ | (Deadline to comment 13 Mar 2025) *No objection from email.*  
No objection.
- d) [25/02028/TTPO](#) | **Proposal:** T.1 Plum - Crown reduce height by 2M and lateral growth by 1.5M to increase light to the rear garden. G.2 - Plum group - Cut back lateral growth from neighbouring Plum trees (trees are located in Elm way woodland area) to the boundary. This has previously been done and the regrowth is approx 1.5M of overhang to cut back. No height reduction. | **Site address:** 6 New Road Melbourn Cambridgeshire | (Deadline to comment 17 Mar 2025) *No objection from email.*  
No objection.

Signed..... Date.....

**PL110/25 Planning Applications:**

- a) INFORMATION ONLY [23/02556/CONDA](#) | **Proposal:** Submission of details required by condition 7 (materials) of planning permission 23/02556/FUL | **Site address:** New Farm Royston Road Melbourn Cambridgeshire SG8 6DH |  
It was noted.
- b) [25/00471/HFUL](#) | **Proposal:** Installation of new gates in the rear garden at the existing access to Chapel Lane. | **Site address:** 91 High Street Melbourn Cambridgeshire | (Deadline to comment: 12 Mar 2025)  
It was RESOLVED to support no comment.  
Proposed by Cllr Clark, seconded by Cllr Barnes. All in favour.
- c) [25/00580/ADV](#) | **Proposal:** Installation of 1 No. externally illuminated projecting/hanging sign, 2 No. externally illuminated Fascia signs, 2 No. non illuminated Fascia Signs, 4 No. externally illuminated replacement corex panels to existing V shaped post sign and 2 No. externally illuminated replacement corex panels to existing post sign. | **Site address:** 105 High Street Melbourn Cambridgeshire (The Dolphin) | (Deadline to comment: 19 Mar 2025)  
It was RESOLVED to support no comment.  
Proposed by Cllr Barnes, seconded by Cllr Wilson. All in favour.

**PL111/25 Permanent Traffic Regulation Order**

- a) To consider permanent traffic regulation order PR1107 in relation to [Melbourn Greenway](#) scheme as issued 3 March 2025. Comment to be made by 24 March 2025.  
Updates to Melbourn Greenway scheme were discussed and traffic regulation order was noted.

**PL112/25 Land transfer**

- a) Update on transfer of LEAP, LAP and residential open space land from Hopkins Homes.  
It was noted that Cllrs Barnes, Clark and Kilmurray had inspected the area and a report of works required would be presented to Full Council and sent to the developers for consideration.

**PL113/25 Correspondence**

- a) To note correspondence from Greater Cambridge Shared Planning in relation to Greater Cambridge Site Submission Update.  
It was noted.

**PL113/25** To note the date of next meeting as **Monday 7 April 2025** at 7.30pm

The date of the next meeting was noted as Monday 7 April. Consideration will be taken by Full Council to move the start time of Planning Committee Meetings to 8pm.

*Meeting closed 19:45*



🏠 **Melbourn Parish Council**  
Melbourn Community Hub  
30 High Street  
Melbourn  
SG8 6DZ

👤 Abi Williams, Clerk  
👤 Alex Coxall, Deputy Clerk  
✉️ parishclerk@melbournparishcouncil.gov.uk  
☎️ 01763 263303, ext 3  
🌐 melbournparishcouncil.gov.uk

---

**MELBOURN PARISH COUNCIL - PLANNING COMMITTEE**  
(District of South Cambridgeshire)

**A meeting of the Planning Committee** held on Monday 10 February 2025 at 19:30  
in the Austen Room, Community Hub, 30 High Street, Melbourn SG8 6DZ

**Present:** Cllrs Barnes, Clark, Kilmurray (Chair)

**Absent:**

**In attendance:** Abi Williams (Parish Clerk)

**PLANNING COMMITTEE: MINUTES**

*Meeting started 19:30*

**PL092/25 To receive and approve apologies for absence**

Apologies received from Cllrs Alexander, Hart and Wilson with acceptable reasons given. It was RESOLVED to accept apologies of absence from Cllrs Alexander, Hart and Wilson. Proposed by Cllr Barnes, seconded by Cllr Clark. All in favour.

**PL093/25 To receive any Declarations of Interest and Dispensations**

- a) To receive declarations of interest from councillors on items on the agenda
- b) To receive written requests for dispensations for disclosable pecuniary interests (if any)
- c) To grant any requests for dispensation as appropriate

None received.

**PL094/25 To approve the minutes of the Planning Committee Meeting on 20 January 2025**

It was RESOLVED to approve the minutes of the Planning Committee Meeting held on 20 January 2025 as an accurate record. Proposed by Cllr Clark, seconded by Cllr Barnes. All in favour.

**PL095/25 To report back on the minutes of the Planning Committee Meetings on 20 January 2025**

Nothing to report.

**PL096/25 Public Participation: (For up to 15 minutes members of the public may contribute their views and comments and questions to the Planning Committee – 3 minutes per item)**

No members of the public were present.

**PL097/25 Decision Notices:** To receive any Decision notices issued since last meeting.

- a) [23/01134/FUL](#) | **Proposal:** Demolition of 13,594sq.m of existing buildings, alterations and extensions by 1,127 sq.m to retained buildings to allow use within Class E within Ash House, Class E(b) within Moat House and Class C1 within the new wing rear of Moat House, development of 46,031 sq.m of new office and technology research facilities (Class E(g)(i), (ii) and (iii)) including continued use of DaVinci building and 22,941 sq.m of ancillary buildings for vehicle and cycle parking, together with temporary and permanent plant and infrastructure works including formation of two additional vehicular accesses and one additional vehicular egress from Cambridge Road and landscaping. | **Site address:** Land At Melbourn Science Park Cambridge Road Melbourn Cambridgeshire |

*MPC Comment:*

*Reservations have not changed and committee wish to request that the Townscape and Visual Impact Assessment shows additional images using 3D modeling from roads in close proximity to the site, including but not limited to Moat Lane, Dury Lane, the entrance from Cambridge row, from the High Street at Sheepshead Row, and at the junction of Cambridge Road and Armingford Crescent. A document of site lines along with What3words coordinates has been uploaded.*

*Previous Comment Date: Thu 13 Apr 2023 It was RESOLVED to support the application with the following comments highlighting serious reservations about the development:*

- \* *The height and scale of buildings resulting in overshadowing and overlooking of neighbouring properties*
- \* *The light pollution from lights on site and the lights from the taller buildings*
- \* *The increased amount of traffic travelling through the village and ensuring the correct conditions are put in place.*

Signed..... Date.....

\* The increased number of car parking spaces and how sustainable travel will be encouraged  
\* Clarification that the health assessment carried out by Savills did consult a medical professional  
\* The increased rental fee which has made use of the premises on the site unaffordable for local businesses.

**Decision:** Application permitted (with conditions) (17 January 2025)

The decision was noted.

- b) [24/04368/FUL](#) | **Proposal:** Erection of 2 No. self/custom build Dwellings. | **Site address:** Land Adjacent To Blakeney's Cambridge Road Melbourn Cambridgeshire SG8 6EY |  
*MPC Comment: Support no comment*

**Decision:** Application withdrawn (17 January 2025)

The decision was noted.

- c) [24/04330/HFUL](#) | **Proposal:** Single storey rear extension and alterations to existing ground floor rear roof shape with installation of roof lights | **Site address:** 4 Greenbanks Melbourn Cambridgeshire SG8 6AS |  
*MPC Comment: Support no comment*

**Decision:** Application permitted (13 January 2025)

The decision was noted.

- d) [22/04904/NMA1](#) | **Proposal:** Non material amendment on application 22/04904/FUL for addition of a single window to living room of Plot 2 (west elevation). | **Site address:** 4 Station Road Melbourn Cambridgeshire SG8 6DX |

**Decision:** Refused application (16 January 2025)

The decision was noted.

- e) [24/04821/SCRE](#) | **Proposal:** EIA Screening Opinion under the Town and Country Planning (Environmental Impact Assessment) Regulations 2017 for a proposed solar farm and battery energy storage system development. | **Site address:** Land South Of Muncceys Farm London Way Melbourn Cambridgeshire SG8 6DJ |

*MPC Comment: No comment*

**Decision:** EIA screening not required (23 January 2025)

The decision was noted.

- f) [24/1455/TTCA](#) | **Proposal:** T1 Sycamore - Reduce branches overhanging thatched roof by up to 4ms. T2 Alder - Reduce branches overhanging thatched roof by up to 4ms. T3 Apple - Crown reduce by up to 3ms. |  
**Site address:** 96 High Street Melbourn Cambridgeshire SG8 6AL |  
*MPC Comment: No comment*

**Decision:** No objection (22 January 2025)

The decision was noted.

- g) [24/1423/TTPO](#) | **Proposal:** T1: 13.7 meters Lime tree - to undergo a crown reduction and thinning by 20% (2.7-meters). This tree was last worked on (approximately five years ago) and has grown back unevenly. This work will restore it towards previous cut points, leaving it healthy and balanced. The proposed work will be to maintain the appropriate size for this tree given it's proximity to the house, letting more light into the property and garden to allow other planting to thrive. | **Site address:** 27 The Lawns Melbourn Cambridgeshire SG8 6BA |

*MPC Comment: No comment*

**Decision:** Tree application permitted (22 January 2025)

The decision was noted.

- h) [23/02556/FUL](#) | **Proposal:** Conversion of a redundant agricultural barn into one dwelling and change of use of agricultural land to residential curtilage, following the granting of Class Q at New Farm, Melbourn. |  
**Site address:** New Farm Royston Road Melbourn Cambridgeshire SG8 6DH |  
*MPC Comment: 15/08/23 It was resolved to OBJECT due to lack of information there is a concern about the adverse impact on nature conservation in this area. Concern was noted about a lack of information regarding how the ecology of the site would be impacted.*

*23/01/25 It was resolved to SUUPPORT no comment.*

**Decision:** Application permitted (27 January 2025)

The decision was noted.

**PL098/25 To note the following applications for tree work:**

Signed..... Date.....

- a) [25/0053/TTCA](#) | **Proposal:** T1, T2 and T3 - Ash - Fell to ground level - Self set tree, leaning due to over shading. | **Site address:** 44 High Street Melbourn Cambridgeshire | (Deadline to comment 10 Feb 2025) *No objection from email. Owner called – application has been withdrawn*  
Noted.
- b) [25/0057/TTCA](#) | **Proposal:** T1 - Prunus - Reduce spread on all sides by up to 2m and shape into remainder of canopy, retaining height. T2 - Beech - Reduce height and spread on all sides by up to 2.5m, down to previous reduction points. | **Site address:** 9 Drury Lane Melbourn Cambridgeshire | (Deadline to comment 10 Feb 2025) *No objection from email.*  
No objection.
- c) [25/0065/TTPO](#) | **Proposal:** Ash - Remove. Reason - There were two large trees near to the property. One fell down in recent winds and the remaining tree is nearer to the house, so we have concerns that if that one also blew over it would cause extensive damage to the house. | **Site address:** 43 The Lawns Melbourn Cambridgeshire SG8 6BA | (Deadline to comment 19 Feb 2025) *Request to confirm need to remove by Inspector.*  
It was RESOLVED to object with request to the tree officer to attend site and confirm tree requires removal. Proposed by Cllr Barnes, seconded by Cllr Clark. All in favour.

**PL099/25 Planning Applications:**

- a) [25/00180/HFUL](#) | **Proposal:** Part garage conversion, single storey side and rear extension. | **Site address:** 46 The Moor Melbourn Cambridgeshire SG8 6ED | (Deadline to comment 11 Feb 2025)  
It was RESOLVED to support no comment.  
Proposed by Cllr Barnes, seconded by Cllr Clark. All in favour.
- b) [25/00025/PRIOR](#) | **Proposal:** Erection of a grain store for the storage and separation of various crops. | **Site address:** Land Adjacent To Garden Centre Cambridge Road Melbourn Cambridgeshire SG8 6RB | (Pending consideration)  
It was RESOLVED to support no comment.  
Proposed by Cllr Clark, seconded by Cllr Barnes. All in favour.

**PL100/25 Licensing – Street Trading Consent**

- a) To consider response to street trading consent – variation to Between Buns STC269921  
It was RESOLVED to support application variation and to note further changes are outside of the Parish.  
Proposed by Cllr Barnes, seconded by Cllr Clark. All in favour.

**PL101/25 Roadworks & Events notifications**

- a) To note roadworks bulletin from Cambridgeshire County Council listing events for Melbourn as:
- 07/02 – 16/03, Melbourn Bypass, multiway signals (UK Power Distribution)
  - 07/02 – 11/02, Station Road, two-way signals (Virgin Media)
  - 04/02 – 06/02, High Street. give and take (Cambridge Water Company)
  - 04/02 – 06/02, Beechwood Ave, multiway signals (Cambridge Water Company)
- Roadwork notifications noted.

**PL102/25 Correspondence**

- a) Cambridgeshire County Council consultation on the proposed 2025 revision of the Local Validation List for planning applications. Consider response.  
Revision reviewed. No comment from Planning Committee.
- b) To consider request to carry out works on trees at Elm Way from resident.  
It was RESOLVED to approve requested works in principle and request a breakdown of works for review.  
Proposed by Cllr Kilmurray, seconded by Cllr Clark. All in favour.
- c) To note update on Melbourn Greenway project from Kerry Allen, Senior Project Manager.  
Verbal update provided. Noting explanation of the need for the speed humps along the High Street and highlighting the need to progress with a public consultation.

- PL102/25** To note the date of the next meeting as **Monday 10 March 2025** at 7.30pm  
The date of the next meeting was noted as Monday 10 March 2025 at 7.30pm.

*Meeting closed 19:46*

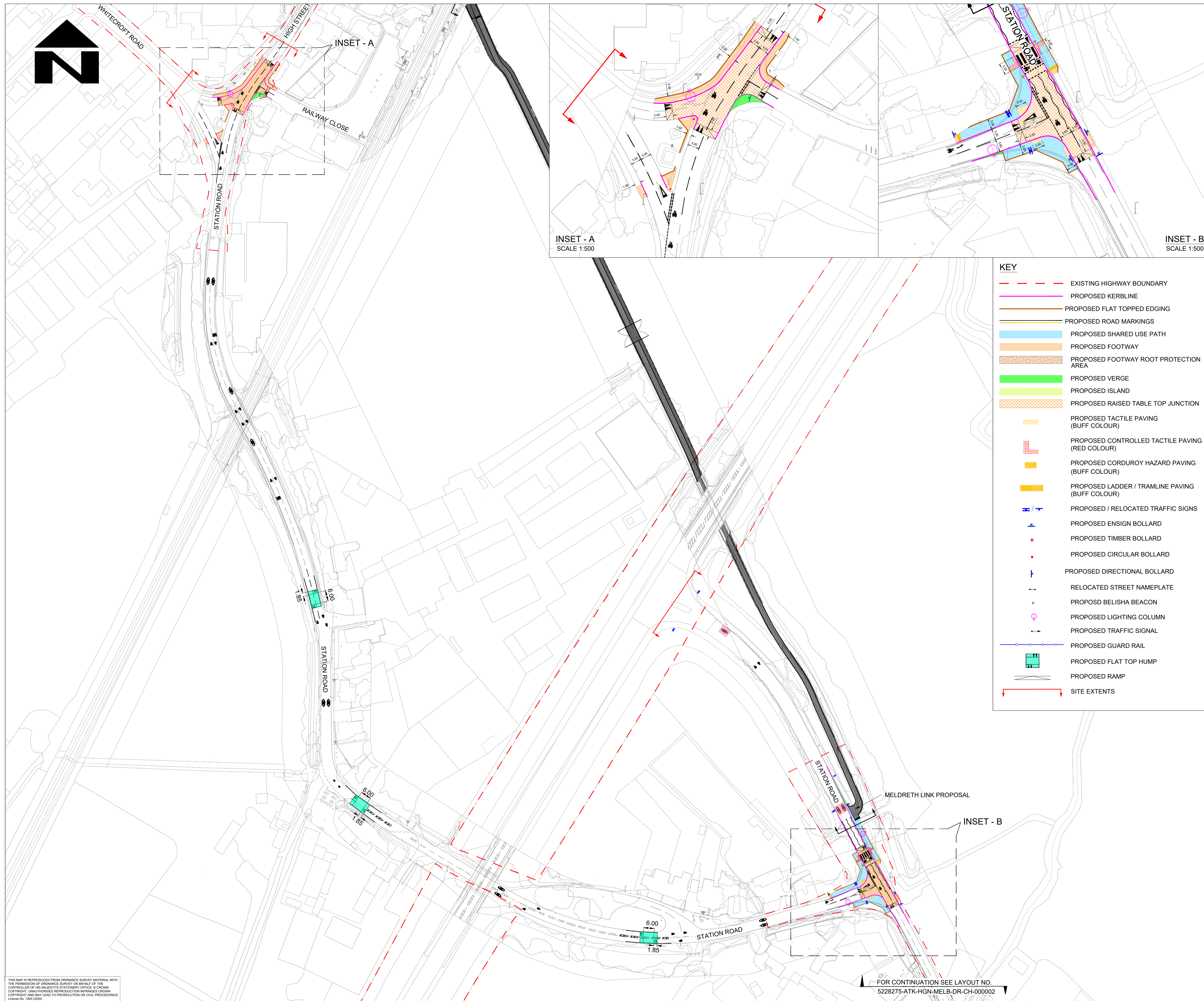

- NOTES**
- DO NOT SCALE FROM THIS DRAWING.
  - ALL DIMENSIONS ARE IN METRES UNLESS OTHERWISE STATED.
  - LIMITS OF WORK ARE APPROXIMATE AND ARE TO BE AGREED ON SITE WITH THE OVERSEEING ORGANISATION.
  - ANY WORK OUTSIDE THE HIGHWAY BOUNDARY NEEDS PRIOR PERMISSION FROM THE LAND OWNER.
  - HEALTH AND SAFETY:  
THE CONTRACTOR SHALL BE AWARE OF ALL STATUTORY UNDERTAKERS PLANT THAT MAY BE LOCATED WITHIN THE SITE. PLANS SHOWING APPROXIMATE LOCATIONS HAVE BEEN SUPPLIED BY ASSET OWNER A SET OF CURRENT (LESS THAN 90 DAYS OLD) C2 RETURNS WILL BE PROVIDED TO THE CONTRACTOR AT THE START OF WORKS.

**KEY**

- EXISTING HIGHWAY BOUNDARY
- PROPOSED KERBLINE
- PROPOSED FLAT TOPPED EDGING
- PROPOSED ROAD MARKINGS
- PROPOSED SHARED USE PATH
- PROPOSED FOOTWAY
- PROPOSED FOOTWAY ROOT PROTECTION AREA
- PROPOSED VERGE
- PROPOSED ISLAND
- PROPOSED RAISED TABLE TOP JUNCTION
- PROPOSED TACTILE PAVING (BUFF COLOUR)
- PROPOSED CONTROLLED TACTILE PAVING (RED COLOUR)
- PROPOSED CORDUROY HAZARD PAVING (BUFF COLOUR)
- PROPOSED LADDER / TRAMLINE PAVING (BUFF COLOUR)
- PROPOSED / RELOCATED TRAFFIC SIGNS
- PROPOSED ENSIGN BOLLARD
- PROPOSED TIMBER BOLLARD
- PROPOSED CIRCULAR BOLLARD
- PROPOSED DIRECTIONAL BOLLARD
- RELOCATED STREET NAMEPLATE
- PROPOSED BELISHA BEACON
- PROPOSED LIGHTING COLUMN
- PROPOSED TRAFFIC SIGNAL
- PROPOSED GUARD RAIL
- PROPOSED FLAT TOP HUMP
- PROPOSED RAMP
- SITE EXTENTS

**SAFETY, HEALTH AND ENVIRONMENTAL INFORMATION**

In addition to the hazards/risks normally associated with the types of work detailed on this drawing, note the following significant residual risks (Reference shall also be made to the design hazard log).

**Construction**  
Presence of live traffic and utilities.  
Presence of tar, soil contamination, asbestos and breaking of concrete not known.

**Maintenance / Cleaning**  
None

**Use**  
None

**Decommissioning / Demolition**  
None

P01	RG	PM	AC	28/06/24
-----	----	----	----	----------

First Issue

P02	SS	ANV	AC	29/01/25
-----	----	-----	----	----------

Road Humps Location Updated and Added 20mph Roundel

P03	DM	ANV	AC	05/02/25
-----	----	-----	----	----------

Lighting Column and Traffic Signal added with other Updates

Rev	Drawn / Des	Checked	Approved	Date

Description

Drawing Status	Suitability
<b>FOR INFORMATION</b>	<b>S2</b>

**AtkinsRéalis**  
5 Wellbrook Court,  
Cambridge  
CB3 0NA

Tel: +44 (0) 1223276002  
www.atkinsrealis.com

Copyright © AtkinsRéalis (2025)  
Client



Project Title  
**Melbourn Greenway Detailed Design**

Drawing Title  
**HIGHWAYS LAYOUT PLAN  
MELBOURN (SCHEME 6)  
(SHEET 1 OF 4)**

Scale	Designed / Drawn	Checked	Approved	Authorised
1:1000	DM	ANV	AC	---
Original Size	Date	Date	Date	Date
A1	05/02/25	05/02/25	05/02/25	---
Drawing Number	Project	Originator	Volume	Job No.
5228275	ATK	HGN	MELB	5228275
Location	Type	Role	Number	Revision
DR	CH	000001	P03	---

THIS MAP IS REPRODUCED FROM ORDNANCE SURVEY MATERIAL WITH THE PERMISSION OF ORDNANCE SURVEY ON BEHALF OF THE CONTROLLER OF HIS MAJESTY'S STATIONERY OFFICE. © CROWN COPYRIGHT. UNAUTHORISED REPRODUCTION INFRINGES CROWN COPYRIGHT AND MAY LEAD TO PROSECUTION OR CIVIL PROCEEDINGS. License No. 1000 23055

FOR CONTINUATION SEE LAYOUT NO.  
5228275-ATK-HGN-MELB-DR-CH-000002

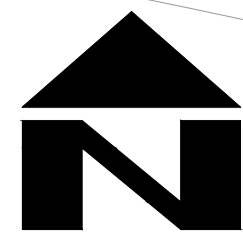

FOR CONTINUATION SEE LAYOUT NO. 5228275-ATK-HGN-MELB-DR-CH-000001

FOR CONTINUATION SEE LAYOUT NO. 5228275-ATK-HGN-MELB-DR-CH-000003

FOR CONTINUATION SEE LAYOUT NO. 5228275-ATK-HGN-MELB-DR-CH-000004

- NOTES**
- DO NOT SCALE FROM THIS DRAWING.
  - ALL DIMENSIONS ARE IN METRES UNLESS OTHERWISE STATED.
  - LIMITS OF WORK ARE APPROXIMATE AND ARE TO BE AGREED ON SITE WITH THE OVERSEEING ORGANISATION.
  - ANY WORK OUTSIDE THE HIGHWAY BOUNDARY NEEDS PRIOR PERMISSION FROM THE LAND OWNER.
  - HEALTH AND SAFETY: THE CONTRACTOR SHALL BE AWARE OF ALL STATUTORY UNDERTAKERS PLANT THAT MAY BE LOCATED WITHIN THE SITE. PLANS SHOWING APPROXIMATE LOCATIONS HAVE BEEN SUPPLIED BY ASSET OWNER. A SET OF CURRENT (LESS THAN 90 DAYS OLD) C2 RETURNS WILL BE PROVIDED TO THE CONTRACTOR AT THE START OF WORKS.

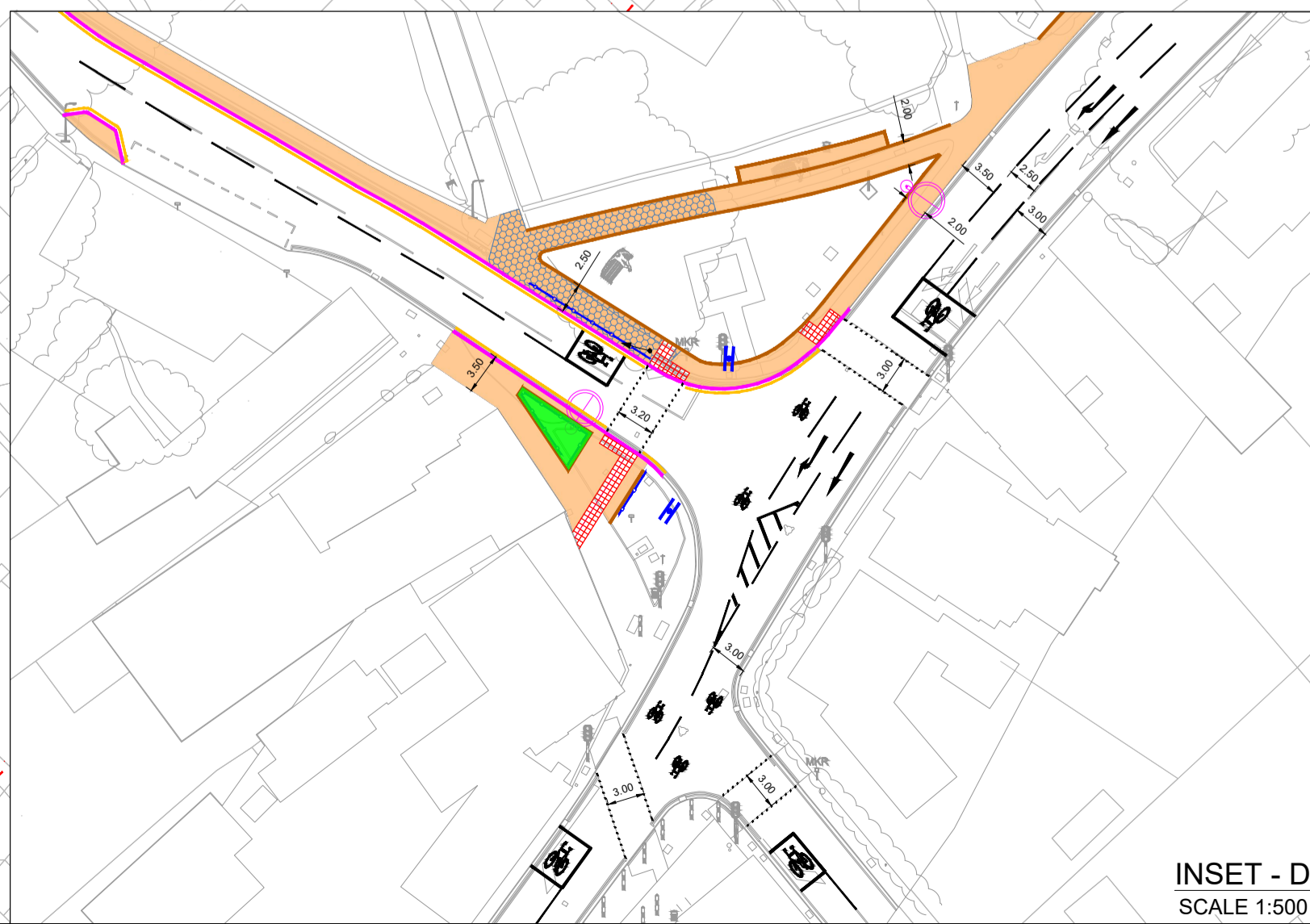
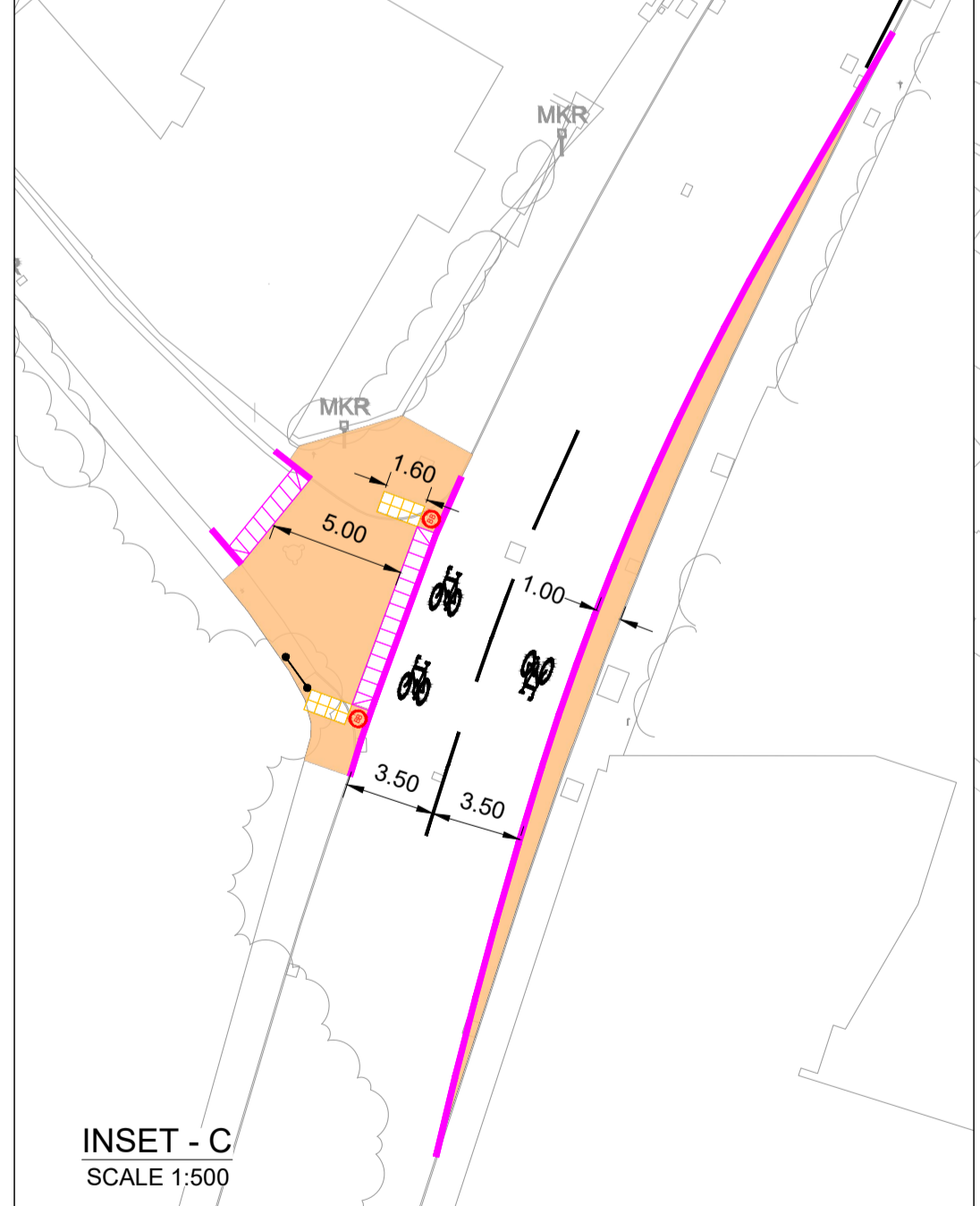
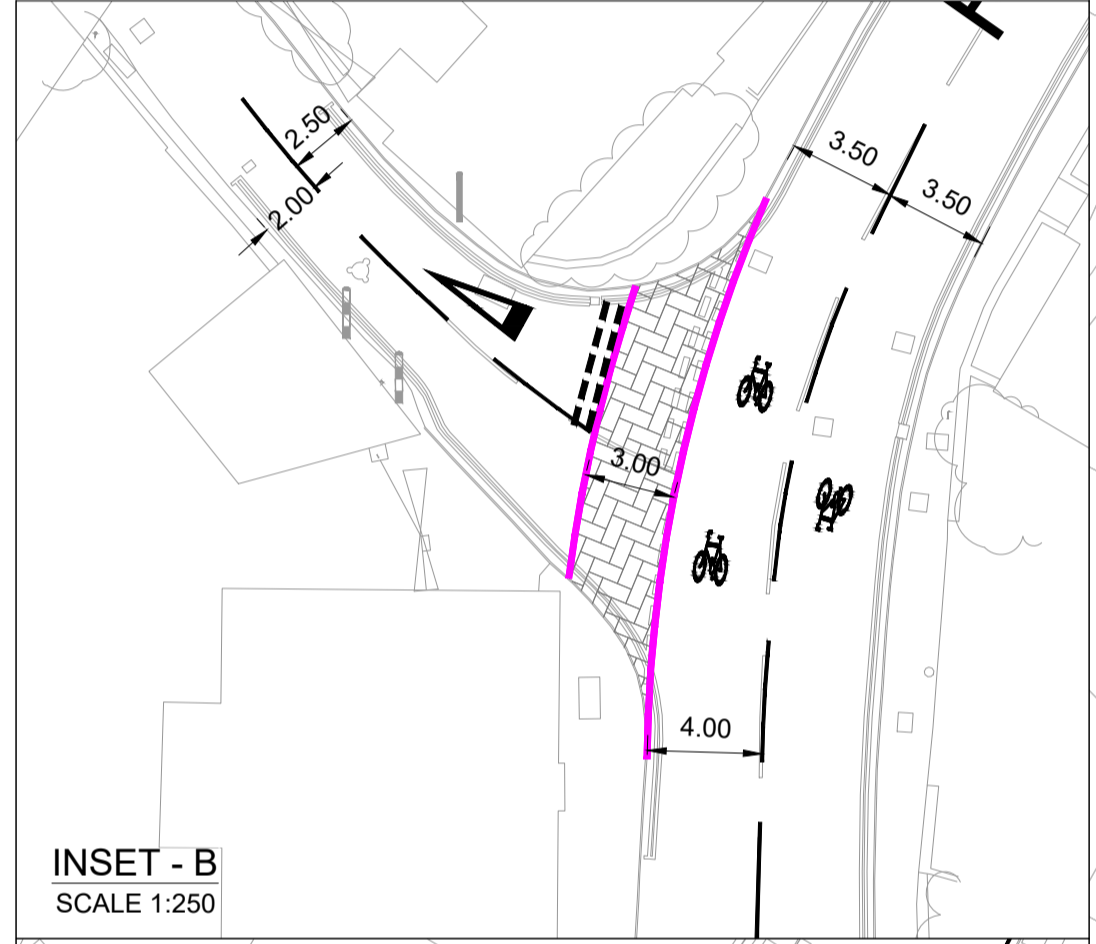
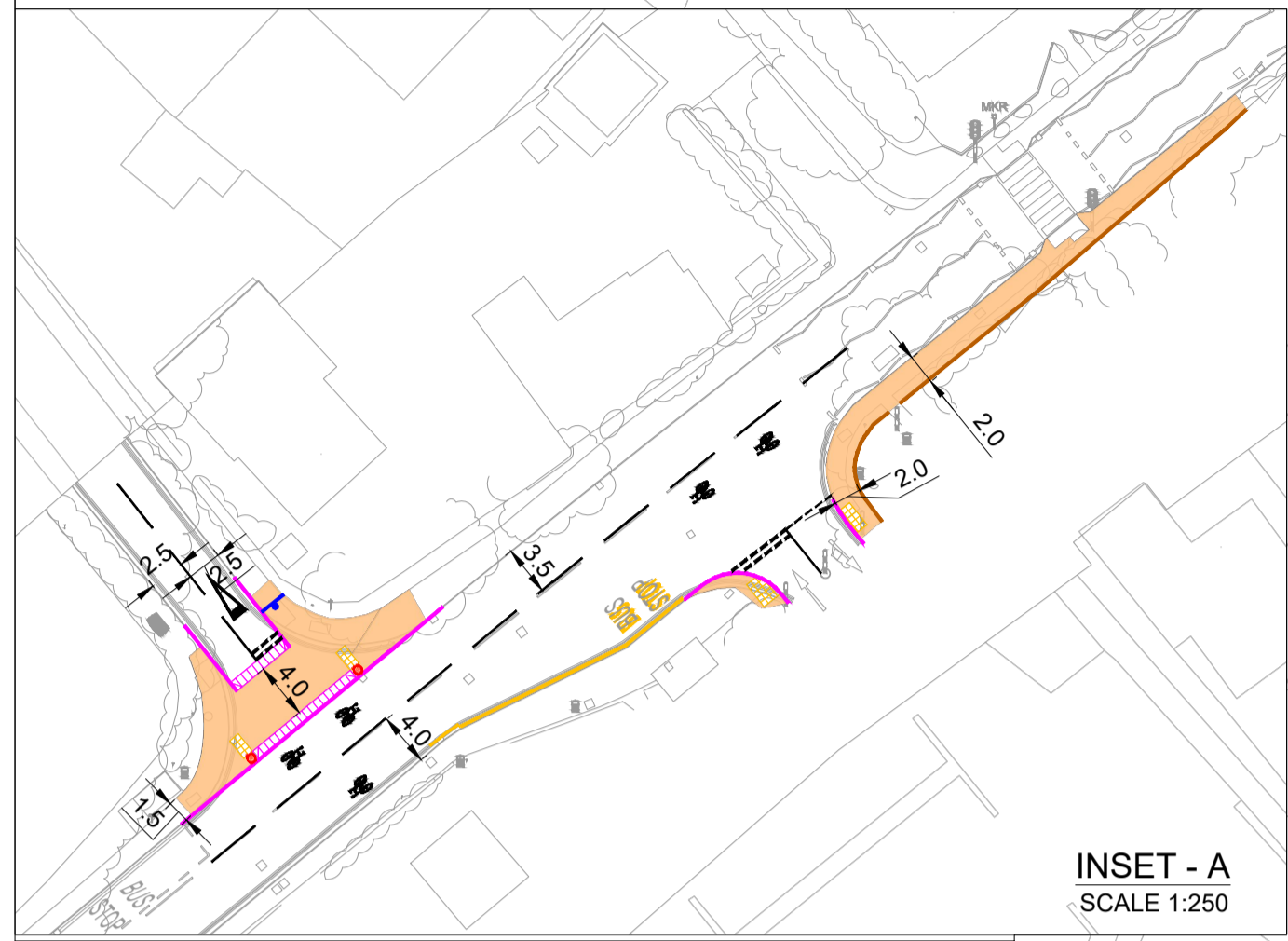

- KEY**
- EXISTING HIGHWAY BOUNDARY
  - PROPOSED KERBLINE
  - PROPOSED FLAT TOPPED EDGING
  - PROPOSED ROAD MARKINGS
  - PROPOSED SHARED USE PATH
  - PROPOSED FOOTWAY
  - PROPOSED FOOTWAY ROOT PROTECTION AREA
  - PROPOSED VERGE
  - PROPOSED ISLAND
  - PROPOSED RAISED TABLE TOP JUNCTION
  - PROPOSED TACTILE PAVING (BUFF COLOUR)
  - PROPOSED CONTROLLED TACTILE PAVING (RED COLOUR)
  - PROPOSED CORDUROY HAZARD PAVING (BUFF COLOUR)
  - PROPOSED LADDER / TRAMLINE PAVING (BUFF COLOUR)
  - PROPOSED / RELOCATED TRAFFIC SIGNS
  - PROPOSED ENSIGN BOLLARD
  - PROPOSED TIMBER BOLLARD
  - PROPOSED CIRCULAR BOLLARD
  - PROPOSED DIRECTIONAL BOLLARD
  - RELOCATED STREET NAMEPLATE
  - PROPOSED BELISHA BEACON
  - PROPOSED LIGHTING COLUMN
  - PROPOSED TRAFFIC SIGNAL
  - PROPOSED GUARD RAIL
  - PROPOSED FLAT TOP HUMPS
  - PROPOSED RAMP
  - SITE EXTENTS

**SAFETY, HEALTH AND ENVIRONMENTAL INFORMATION**

In addition to the hazards/risks normally associated with the types of work detailed on this drawing, note the following significant residual risks (Reference shall also be made to the design hazard log).

**Construction**  
Presence of live traffic and utilities.  
Presence of tar, soil contamination, asbestos and breaking of concrete not known.

**Maintenance / Cleaning**  
None

**Use**  
None

**Decommissioning / Demolition**  
None

P01	RG	PM	AC	28/06/24
-----	----	----	----	----------

First Issue

P02	SS	ANV	AC	29/01/25
-----	----	-----	----	----------

Road Humps Location Updated and Added 20mph Roundel

P03	DM	ANV	AC	05/02/25
-----	----	-----	----	----------

Lighting Column and Traffic Signal added with other Updates

Rev	Drawn / Des	Checked	Approved	Date

Drawing Status	FOR INFORMATION	Suitability	S2
----------------	-----------------	-------------	----

**AtkinsRéalis**  
5 Wellbrook Court,  
Cambridge  
CB3 0NA  
Tel: +44 (0) 122376002  
www.atkinsrealis.com

Copyright © AtkinsRéalis (2025)  
Client  
**GREATER CAMBRIDGE PARTNERSHIP**  
Growing and sharing prosperity  
Delivering our City Deal

Project Title  
**Melbourn Greenway Detailed Design**

Drawing Title  
**HIGHWAYS LAYOUT PLAN MELBOURN (SHEET 6) (SHEET 2 OF 4)**

Scale	Designed / Drawn	Checked	Approved	Authorised
1:1000	DM	ANV	AC	---
Original Size	Date	Date	Date	Date
A1	05/02/25	05/02/25	05/02/25	---

Drawing Number	Project	Originator	Volume	Job No.
5228275	ATK HGN MELB	DR CH	000002	5228275
Location	Type	Role	Number	Revision
				P03

THIS MAP IS REPRODUCED FROM ORDNANCE SURVEY MATERIAL WITH THE PERMISSION OF ORDNANCE SURVEY ON BEHALF OF THE CONTROLLER OF HIS MAJESTY'S STATIONERY OFFICE. © CROWN COPYRIGHT. UNAUTHORISED REPRODUCTION INFRINGES CROWN COPYRIGHT AND MAY LEAD TO PROSECUTION OR CIVIL PROCEEDINGS. License No. 1000 23025

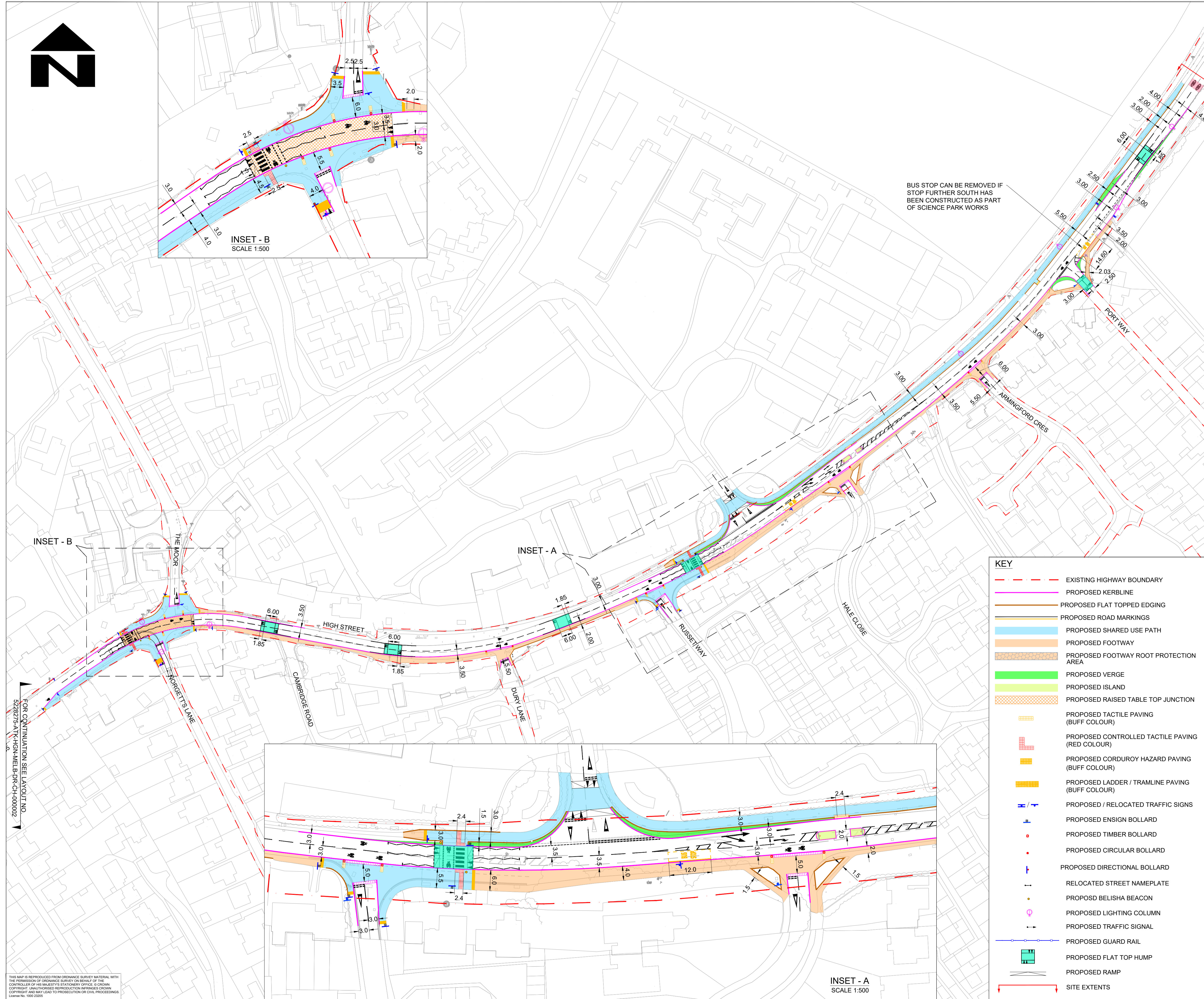
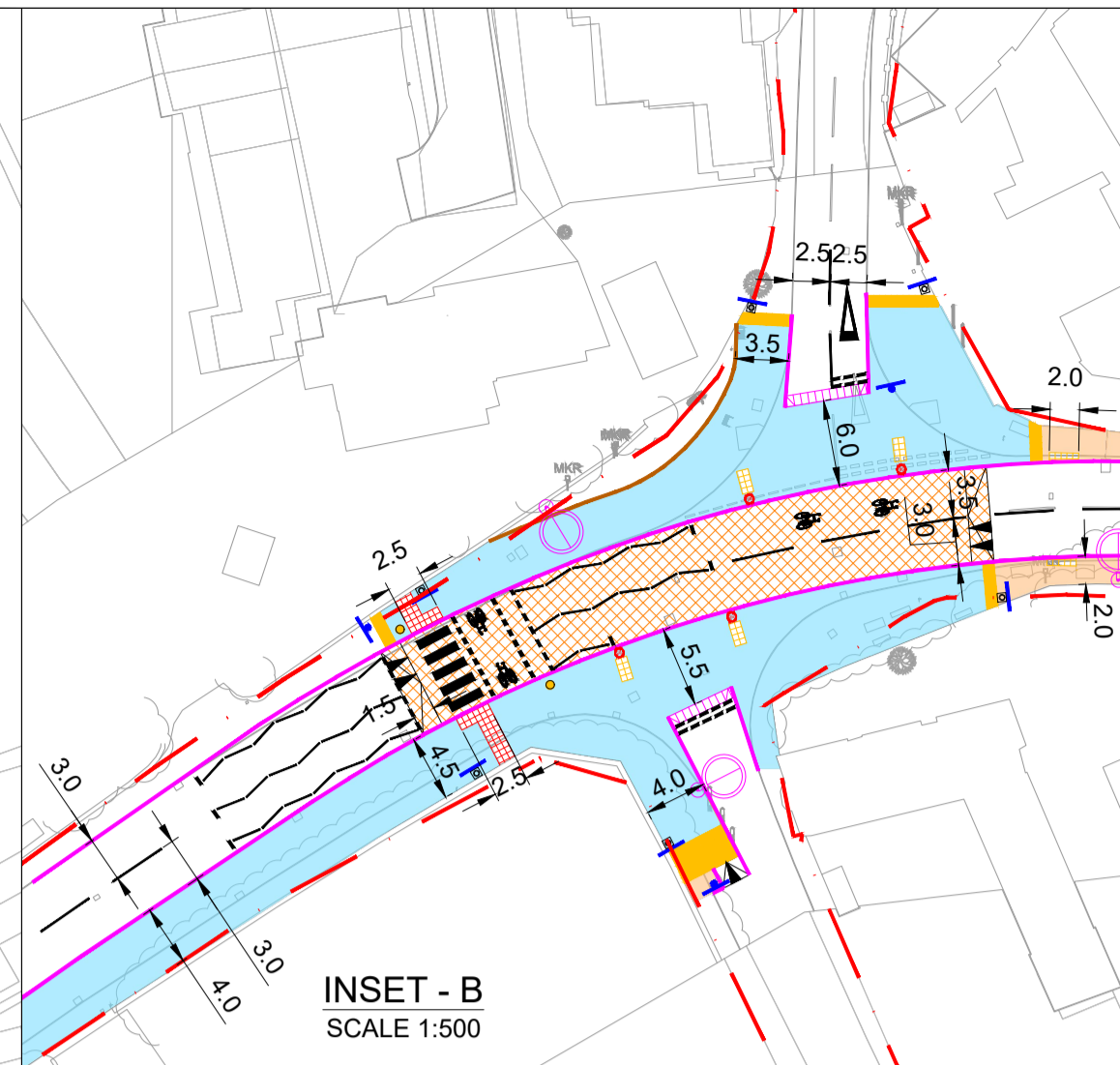
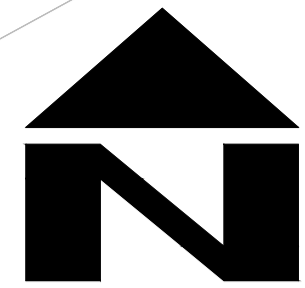

BUS STOP CAN BE REMOVED IF STOP FURTHER SOUTH HAS BEEN CONSTRUCTED AS PART OF SCIENCE PARK WORKS

**KEY**

- EXISTING HIGHWAY BOUNDARY
- PROPOSED KERBLINE
- PROPOSED FLAT TOPPED EDGING
- PROPOSED ROAD MARKINGS
- PROPOSED SHARED USE PATH
- PROPOSED FOOTWAY
- PROPOSED FOOTWAY ROOT PROTECTION AREA
- PROPOSED VERGE
- PROPOSED ISLAND
- PROPOSED RAISED TABLE TOP JUNCTION
- PROPOSED TACTILE PAVING (BUFF COLOUR)
- PROPOSED CONTROLLED TACTILE PAVING (RED COLOUR)
- PROPOSED CORDUROY HAZARD PAVING (BUFF COLOUR)
- PROPOSED LADDER / TRAMLINE PAVING (BUFF COLOUR)
- PROPOSED / RELOCATED TRAFFIC SIGNS
- PROPOSED ENSIGN BOLLARD
- PROPOSED TIMBER BOLLARD
- PROPOSED CIRCULAR BOLLARD
- PROPOSED DIRECTIONAL BOLLARD
- RELOCATED STREET NAMEPLATE
- PROPOSED BELISHA BEACON
- PROPOSED LIGHTING COLUMN
- PROPOSED TRAFFIC SIGNAL
- PROPOSED GUARD RAIL
- PROPOSED FLAT TOP HUMPS
- PROPOSED RAMP
- SITE EXTENTS

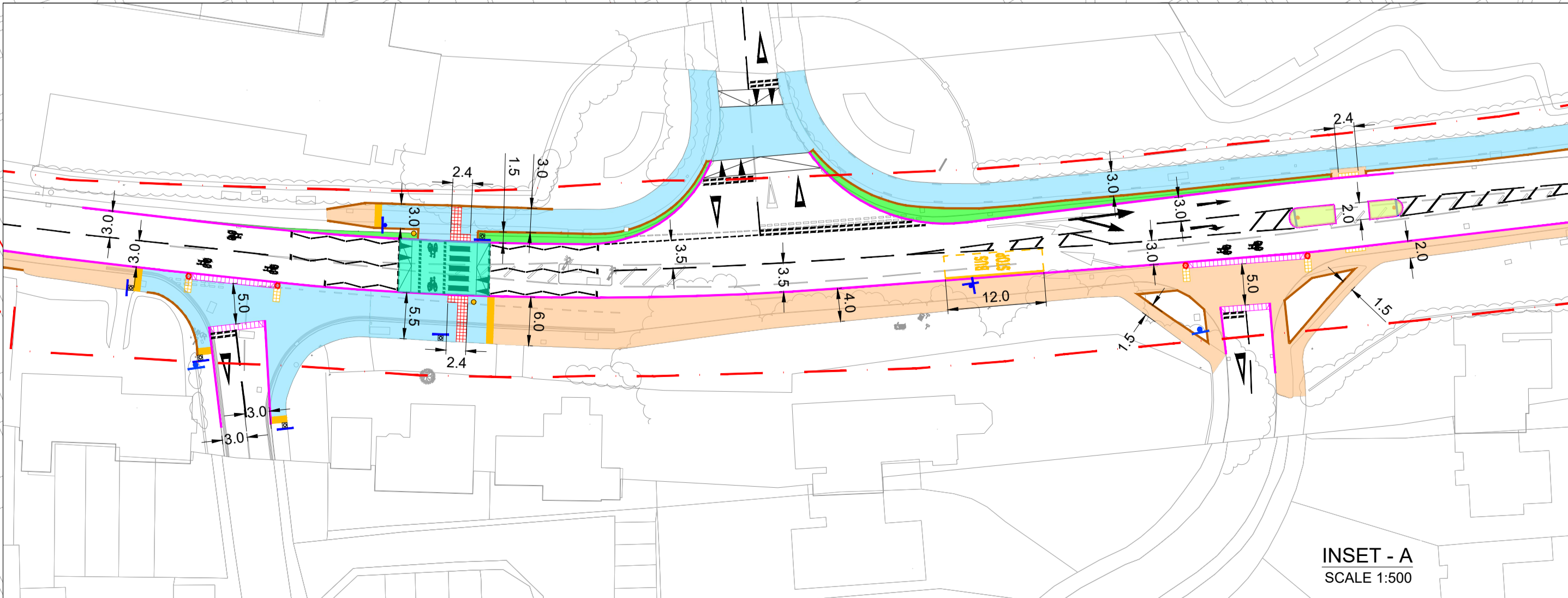

- NOTES**
1. DO NOT SCALE FROM THIS DRAWING.
  2. ALL DIMENSIONS ARE IN METRES UNLESS OTHERWISE STATED.
  3. LIMITS OF WORK ARE APPROXIMATE AND ARE TO BE AGREED ON SITE WITH THE OVERSEEING ORGANISATION.
  4. ANY WORK OUTSIDE THE HIGHWAY BOUNDARY NEEDS PRIOR PERMISSION FROM THE LAND OWNER.
  5. HEALTH AND SAFETY:  
THE CONTRACTOR SHALL BE AWARE OF ALL STATUTORY UNDERTAKERS PLANT THAT MAY BE LOCATED WITHIN THE SITE. PLANS SHOWING APPROXIMATE LOCATIONS HAVE BEEN SUPPLIED BY ASSET OWNER. A SET OF CURRENT (LESS THAN 90 DAYS OLD) C2 RETURNS WILL BE PROVIDED TO THE CONTRACTOR AT THE START OF WORKS.

**SAFETY, HEALTH AND ENVIRONMENTAL INFORMATION**

In addition to the hazards/risks normally associated with the types of work detailed on this drawing, note the following significant risks (Reference shall also be made to the design hazard log).

Construction  
Presence of live traffic and utilities.  
Presence of tar, soil contamination, asbestos and breaking of concrete not known.

Maintenance / Cleaning  
None

Use  
None

Decommissioning / Demolition  
None

P01	RG	PM	AC	28/06/24
First Issue				
P02	SS	ANV	AC	29/01/25
Road Humps Location Updated and Added 20mph Roundel				
P03	DM	ANV	AC	05/02/25
Lighting Column and Traffic Signal added with other Updates				
Rev	Drawn / Des	Checked	Approved	Date
Description				

Drawing Status	Suitability
<b>FOR INFORMATION</b>	<b>S2</b>

**AtkinsRéalis**  
5 Wellbrook Court,  
Cambridge  
CB3 0NA  
Tel: +44 (0) 1223276002  
www.atkinsrealis.com

Copyright © AtkinsRéalis (2025)  
Client: **GREATER CAMBRIDGE PARTNERSHIP**  
Growing and sharing prosperity  
Delivering our City Deal

Project Title  
**Melbourn Greenway Detailed Design**

Drawing Title  
**HIGHWAYS LAYOUT PLAN MELBOURN (SCHEME 6) (SHEET 3 OF 4)**

Scale	1:1000	Designed / Drawn	DM	Checked	ANV	Approved	AC	Authorised	---
Original Size	A1	Date	05/02/25	Date	05/02/25	Date	05/02/25	Date	---
Drawing Number	5228275	Project	ATK	Originator	HGN	Volume	MELB	Job No.	5228275
Location	DR	Type	CH	Role	000003	Number		Revision	P03

THIS MAP IS REPRODUCED FROM ORDNANCE SURVEY MATERIAL WITH THE PERMISSION OF ORDNANCE SURVEY ON BEHALF OF THE CONTROLLER OF HIS MAJESTY'S STATIONERY OFFICE. © CROWN COPYRIGHT. UNAUTHORISED REPRODUCTION INFRINGES CROWN COPYRIGHT AND MAY LEAD TO PROSECUTION OR CIVIL PROCEEDINGS. License No. 1000 23055  
CAD FILE: C:\projectwise\atkins\_transportation\_uk\id0439168\5228275-ATK-HGN-MELB-DR-CH-000003.dwg

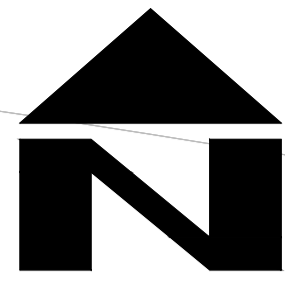

FOR CONTINUATION SEE LAYOUT NO. 5228275-ATK-HGN-MELB-DR-CH-000002

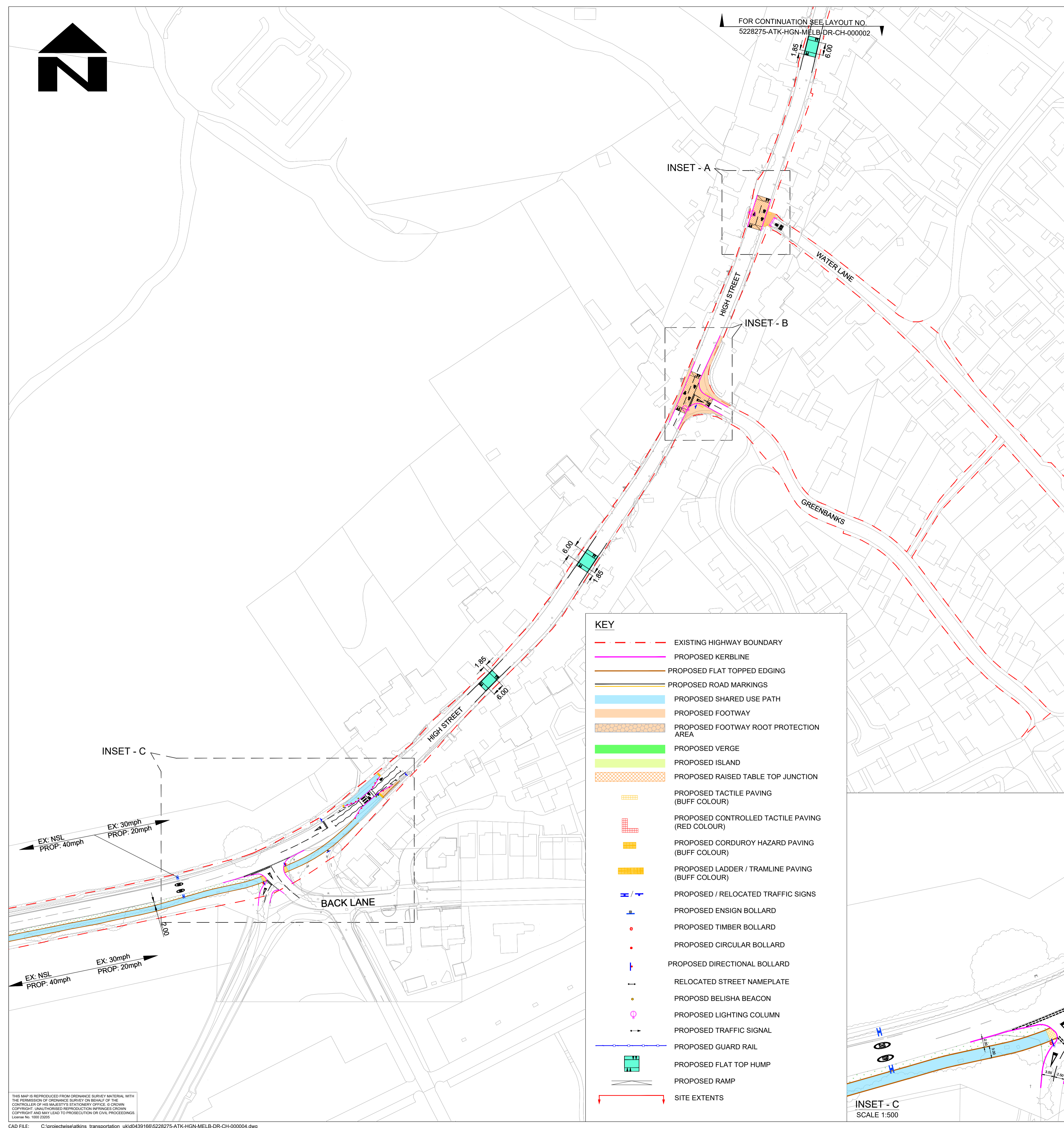

**KEY**

- EXISTING HIGHWAY BOUNDARY
- PROPOSED KERBLINE
- PROPOSED FLAT TOPPED EDGING
- PROPOSED ROAD MARKINGS
- PROPOSED SHARED USE PATH
- PROPOSED FOOTWAY
- PROPOSED FOOTWAY ROOT PROTECTION AREA
- PROPOSED VERGE
- PROPOSED ISLAND
- PROPOSED RAISED TABLE TOP JUNCTION
- PROPOSED TACTILE PAVING (BUFF COLOUR)
- PROPOSED CONTROLLED TACTILE PAVING (RED COLOUR)
- PROPOSED CORDUROY HAZARD PAVING (BUFF COLOUR)
- PROPOSED LADDER / TRAMLIN PAVING (BUFF COLOUR)
- PROPOSED / RELOCATED TRAFFIC SIGNS
- PROPOSED ENSIGN BOLLARD
- PROPOSED TIMBER BOLLARD
- PROPOSED CIRCULAR BOLLARD
- PROPOSED DIRECTIONAL BOLLARD
- RELOCATED STREET NAMEPLATE
- PROPOSED BELISHA BEACON
- PROPOSED LIGHTING COLUMN
- PROPOSED TRAFFIC SIGNAL
- PROPOSED GUARD RAIL
- PROPOSED FLAT TOP HUMPS
- PROPOSED RAMP
- SITE EXTENTS

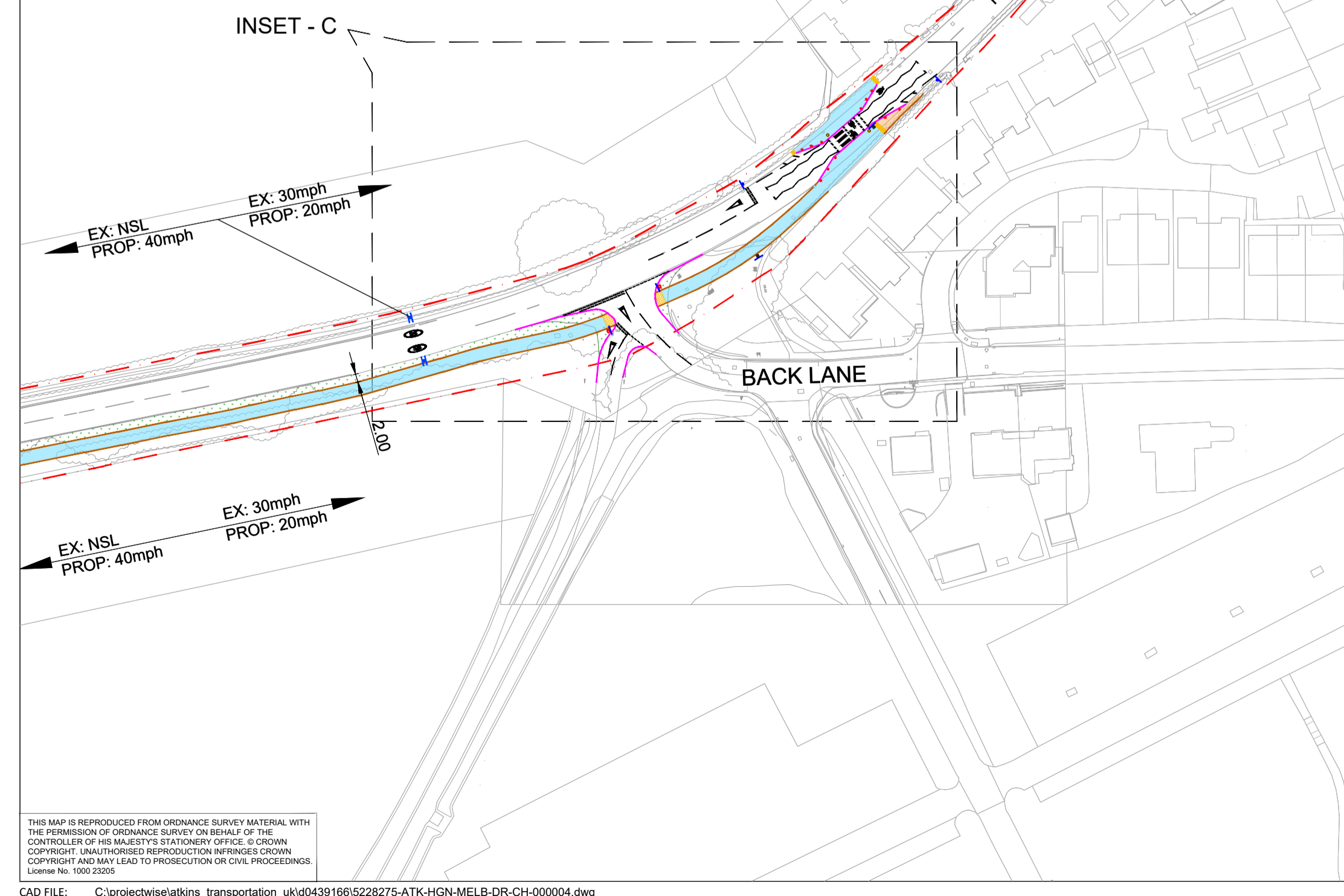
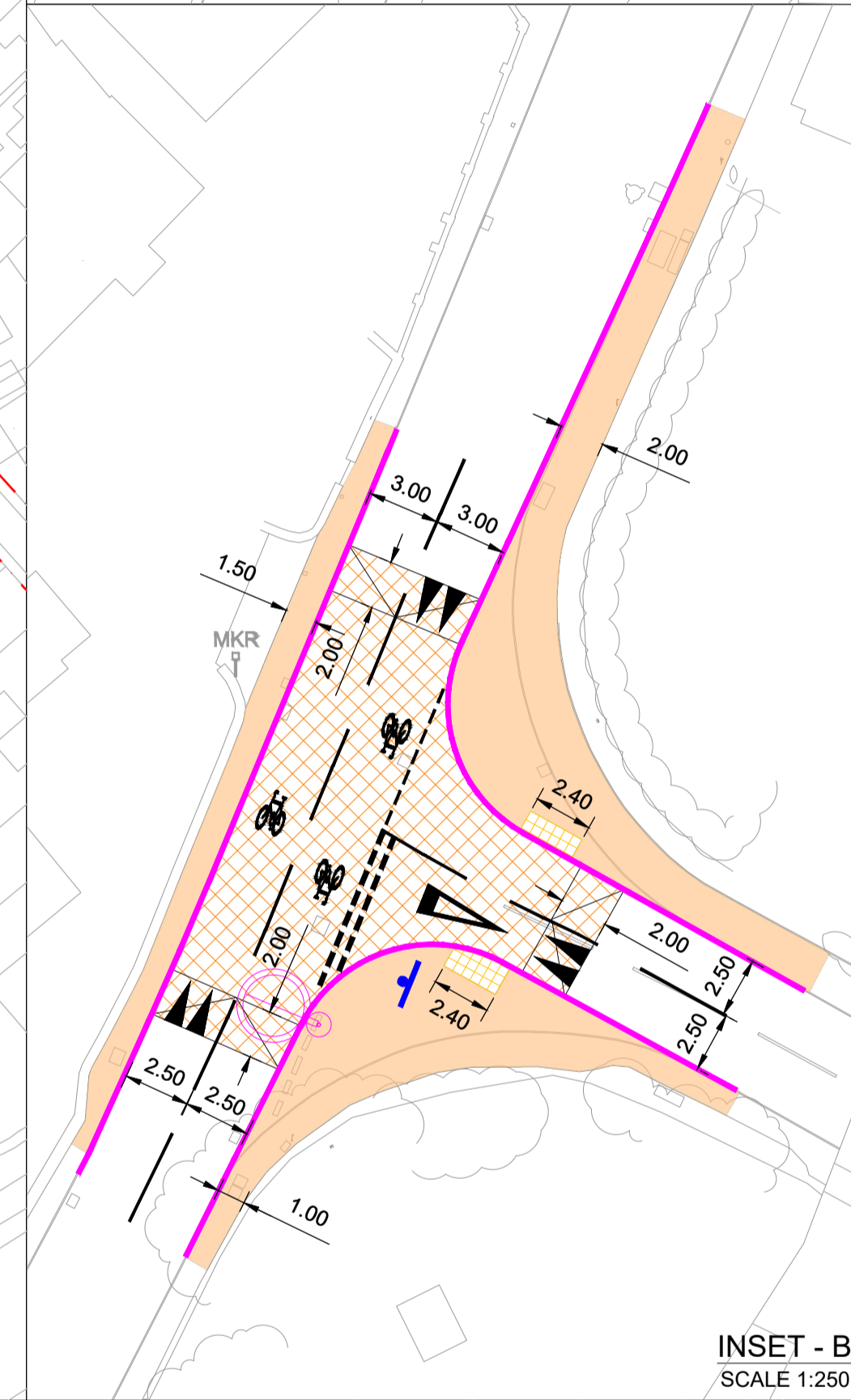

- NOTES**
- DO NOT SCALE FROM THIS DRAWING.
  - ALL DIMENSIONS ARE IN METRES UNLESS OTHERWISE STATED.
  - LIMITS OF WORK ARE APPROXIMATE AND ARE TO BE AGREED ON SITE WITH THE OVERSEEING ORGANISATION.
  - ANY WORK OUTSIDE THE HIGHWAY BOUNDARY NEEDS PRIOR PERMISSION FROM THE LAND OWNER.
  - HEALTH AND SAFETY: THE CONTRACTOR SHALL BE AWARE OF ALL STATUTORY UNDERTAKERS PLANT THAT MAY BE LOCATED WITHIN THE SITE. PLANS SHOWING APPROXIMATE LOCATIONS HAVE BEEN SUPPLIED BY ASSET OWNER. A SET OF CURRENT (LESS THAN 90 DAYS OLD) C2 RETURNS WILL BE PROVIDED TO THE CONTRACTOR AT THE START OF WORKS.

**SAFETY, HEALTH AND ENVIRONMENTAL INFORMATION**

In addition to the hazards/risks normally associated with the types of work detailed on this drawing, note the following significant residual risks (Reference shall also be made to the design hazard log).

**Construction**  
Presence of live traffic and utilities.  
Presence of tar, soil contamination, asbestos and breaking of concrete not known.

**Maintenance / Cleaning**  
None

**Use**  
None

**Decommissioning / Demolition**  
None

P01	RG	PM	AC	28/06/24
-----	----	----	----	----------

First Issue

P02	SS	ANV	AC	29/01/25
-----	----	-----	----	----------

Road Humps Location Updated and Added 20mph Roundel

P03	DM	ANV	AC	05/02/25
-----	----	-----	----	----------

Lighting Column and Traffic Signal added with other Updates

Rev	Drawn / Des	Checked	Approved	Date
Description				

FOR INFORMATION



5 Wellbrook Court, Cambridge CB3 0NA  
Tel: +44 (0) 1223276002  
www.atkinsrealis.com

Copyright © AtkinsRéalis (2025)



Project Title  
**Melbourn Greenway Detailed Design**

Drawing Title  
**HIGHWAYS LAYOUT PLAN MELBOURN (SCHEME 6) (SHEET 4 OF 4)**

Scale	Designed / Drawn	Checked	Approved	Authorised
1:1000	DM	ANV	AC	---
Original Size	Date	Date	Date	Date
A1	05/02/25	05/02/25	05/02/25	---
Drawing Number	Project	Originator	Volume	Job No.
5228275	DR	ATK CH	HGN MELB 000004	5228275
Location	Type	Role	Number	Revision
				P03

THIS MAP IS REPRODUCED FROM ORDNANCE SURVEY MATERIAL WITH THE PERMISSION OF ORDNANCE SURVEY ON BEHALF OF THE CONTROLLER OF HIS MAJESTY'S STATIONERY OFFICE. © CROWN COPYRIGHT. UNAUTHORISED REPRODUCTION INFRINGES CROWN COPYRIGHT AND MAY LEAD TO PROSECUTION OR CIVIL PROCEEDINGS. License No. 1000 23055

**CAMBRIDGESHIRE COUNTY COUNCIL**  
**HIGHWAYS ACT 1980 AS AMENDED BY THE TRANSPORT ACT 1981**  
**(SECTIONS 90A TO 90F)**  
**THE HIGHWAYS (ROAD HUMPS) REGULATIONS 1999**

**NOTICE OF INTENTION TO INSTALL TRAFFIC CALMING IN MELBOURN, AND MELDRETH**

NOTICE is hereby given that Cambridgeshire County Council proposes to install raised tables, all 75mm in height according to the below schedule:

Location	Parish
High Street at its junction with Station Approach	Meldreth
Whitcroft Road at a point approximately 20 metres south of its junction with High Street	Meldreth
Near to 1 Station Road	Meldreth
Near to 32 Station Road	Meldreth
Near to 53 Station Road	Meldreth
At the junction of Station Road, a point approximately 210 metres south east of its junction with the A10	Meldreth
Near to 28 Station Road	Melbourn
Near to 75a High Street	Melbourn
At the junction of Rose Lane and High Street	Melbourn
At the junction of 85a High Street	Melbourn
Near to 101 High Street	Melbourn
At the junction of Dolphin Lane and High Street	Melbourn
Near to 119 High Street	Melbourn
At the junction of Water Lane and High Street	Melbourn
At the junction of Green Banks and High Street	Melbourn
Near to 151 High Street	Melbourn
Near to 122 High Street	Melbourn
At the junction of Vicarage Close	Melbourn
Near to 29a High Street	Melbourn
At the junction of Norgett's Lane, High Street, The Moor and Cambridge Road	Melbourn
Near to 21 High Street	Melbourn
Near to 9 Sheepshead Row / 9 High Street	Melbourn
At the junction of Dury Lane and High Street	Melbourn
Near to 1b Drury Lane	Melbourn
At the junction of Russet Way	Melbourn
Near to 12 Cambridge Road	Melbourn
At the junction of Melbourn Science Park and Cambridge Road	Melbourn
At the junction of Cambridge Road and Hale Close	Melbourn

At the junction of Cambridge Road and Armingford Crescent	Melbourn
Portway at a point approximately 8 metres southeast of its junction with Cambridge Road	Melbourn
Cambridge Road, at a point approximately 75 metres northeast of its junction with Portway	Melbourn

A map showing the roads and lengths of road concerned, may be examined at the office of the undersigned and at the office of Highways Service, Stanton House, Stanton Way, Huntingdon PE29 6XL by appointment only or by using the link <https://shorturl.at/cjnIQ>. Documents are also available at Great Shelford Library CB22 5LZ

Objections to these proposals, together with the grounds on which they are made or any additional comments, must be sent in writing to the undersigned or by email to [policyandregulation@cambridgeshire.gov.uk](mailto:policyandregulation@cambridgeshire.gov.uk) by 24<sup>th</sup> March quoting reference PR1107. Comments will be used as part of our consultation process and may be published, anonymised, in reports to Committees.

### **Notice of Intention to Install Pedestrian and Cycle Crossing**

Cambridgeshire County Council hereby gives notice of its intention to install a 'zebra' pedestrian crossing with a parallel pedal cycle crossing facility under powers contained in the Road Traffic Regulation Act 1984, centred upon the following locations:-

Station Road, Melbourn at a point approximately 223metres north of its junction with Dolphin Lane.

High Street, Melbourn at a point approximately 63 metres northeast of its junction with Back Lane.

High Street, Melbourn at a point approximately 10 metres west of its junction with Norgetts Lane.

Cambridge Road, Melbourn at a point approximately 25 metres east of its junction with Russet Way.

These constructs are intended to provide safe crossing places for both pedestrians and cyclists.

### **Highways Act 1980 S.65(1) and S.66(4) Conversion of Footways to Cycle Tracks**

Cambridgeshire County Council, in exercise of its powers under the above-named Act, intends to convert part of the footways to shared use cycle tracks in Melbourn:

Around the junction of Back Lane and High Street.

Around the junctions of Norgett's Lane, The Moor, and the High Street.

Around the junctions of Russet Way and Melbourn Science Park and on Cambridge Road, north side, up until a point approximately 275 northeast of the same junction.

*Frank Jordan, Executive Director: Place and Sustainability, c/o Policy and Regulation, Unit 1a, Vantage House, Vantage Park, 9 Washingley Rd, Huntingdon PE29 6SR*



HOPKINS  
HOMES



Melbourn Parish Council  
Melbourn Community Hub  
30 High Street  
Melbourn  
SG8 6DZ

10 February 2025

Dear Sirs

**Land at New Road, Melbourn  
S106 obligation Adoption of LEAP, LAP and Residential Open Space**

We have now completed our development at Kingsley Grove, Melbourn and would like to progress the adoption of the LEAP, LAP and other incidental residential open space pockets within the development to Melbourn Parish Council.

For ease of reference, I attach a plan "Melbourn Incidental Green Space" previously provided identifying (numbering) the pockets of residential open space. Area 5 is the LAP and Area 9 the LEAP. A draft conveyance plan, landscape drawings and landscape management plan are also enclosed.

In accordance with the S106 obligations at Schedule 2, part 2:-

The areas have been laid out and maintained by Hopkins Homes. A Landscape Architect from Greater Cambridgeshire has issued a Certificate of Practical Completion.

As previously agreed, the incidental residential open space pockets to be transferred to Melbourn Parish Council at the end of development upon payment of consideration of £1.00.

The LEAP and LAP to be transferred to Melbourn Parish Council upon payment of consideration of £1 and a maintenance contribution representing a sufficient sum for 10 years maintenance.

We would like to propose to the Parish Council a sum of £70,000 (seventy thousand pounds) for the 10 years maintenance contribution of the LEAP and LAP areas.

Please let me know if you require any further information, otherwise look forward to your response to our proposal in order that we can move forward to progress the transfer.

Yours faithfully

Sharon Levell  
Planning Co-ordinator

Encs

## Abi Williams

---

**From:** LocalPlan (GC) <localplan@greatercambridgeplanning.org>  
**Sent:** 14 February 2025 09:03  
**To:** LocalPlan (GC)  
**Cc:** Abington Piggotts; Arrington; Babraham; Balsham; Bar Hill; Barrington; Bartlow; Barton; Bassingbourn; Bassingbourn Chair; Bourn; Caldecote; Cambourne; Carlton cum Willingham; Castle Camps; Caxton; Caxton 2; Childerley; Comberton; Coton; Cottenham; Croxton; croydonpc@bobburling.plus.com; Dry Drayton; Dry Drayton Chair; Duxford; Elsworth; Eltisley; Eversdens; Fen Ditton 2; Fen Drayton; Fowlmere; Fowlmere Chair; Foxton; Fulbourn; Gamlingay; Girton; Grantchester; Graveley; Great & Little Chishill; Great & Little Chishill Chair; Great Abington & Hildersham; Great Shelford; Great Wilbraham; Guilden Morden; Hardwick; Harlton; Harston; Haslingfield; Haslingfield Chairman; Hatley; Hauxton2; Heydon; Hinxton; Histon & Impington; Histon & Impington 2; Horningsea; Horseheath; Ickleton; Ickleton 2; Kingston; Landbeach; Linton; Litlington; Little Abington; Little Gransden; Little Shelford; Little Wilbraham & Six Mile Bottom; Longstanton; Longstowe; Madingley; Abi Williams; Melbourn Chair; Assistant Clerk; Meldreth; Meldreth Chair; Milton; Newton; Northstowe; Oakington & Westwick; Orchard Park; Orwell; Over; Pampisford; Papworth Everard; Rampton; Sawston; Shepreth; Shingay-cum-Wendy; Shudy Camps; Stapleford; Stapleford 2; Stow-cum-Quy; Swavesey; Teversham; Thriplow; Toft; Waterbeach; West Wickham & West Wrattling; Weston Collville 1; Weston Collville 2; Whaddon; Whittlesford; Willingham  
**Subject:** Greater Cambridge: Site Submission Update  
**Follow Up Flag:** Follow up  
**Flag Status:** Flagged

Dear Parish Councils

Today the Councils have asked landowners, developers and site promoters for updates on site submissions as part of the preparation of the [Greater Cambridge Local Plan](#). Since 2019, the councils have received around 700 sites through the 'Call for Sites' process, where interested parties have submitted sites for potential allocation in the new Local Plan. The Councils' have assessed these sites, and more, but have not been registering any further sites or additional information on existing sites since May 2022 in order to complete assessments and manage the flow of information submitted.

Ahead of the [proposed consultation on the draft Local Plan this autumn](#), the councils have launched a three week update exercise where promoters can submit new sites or updated information, in order for the Councils' to have the most up to date information as the draft Local Plan is prepared. We would like to highlight that this is a normal part of the Plan making process.

We intend to publish any new sites or information we receive in the summer, with any assessments published in the Housing and Employment Land Availability Assessment (HELAA) alongside the draft Local Plan. It is at the draft Local Plan consultation stage where everyone will have the opportunity to comment on the Plan or specific policies or sites within it.

Finally, you will be aware that the Councils recently published an update on the [new housebuilding targets](#) for this area. This is not related to the Site Submission update, which is being undertaken solely to inform the joint Local Plan process.

If you have any questions about this process, then please do not hesitate to contact us.

Kind regards

Planning Policy and Strategy team  
Greater Cambridge Shared Planning



Greater Cambridge Shared Planning Service

South Cambridgeshire Hall | Cambourne Business Park | Cambourne | Cambridge | CB23 6EA

The Guildhall | Market Square | Cambridge | CB2 3QJ

t: 01954 713694

[www.greatercambridgeplanning.org](http://www.greatercambridgeplanning.org) | [www.cambridge.gov.uk](http://www.cambridge.gov.uk) | [www.scambs.gov.uk](http://www.scambs.gov.uk) | [Facebook](#) | [Instagram](#) | [LinkedIn](#)

The Greater Cambridge Shared Planning Service is a strategic partnership between Cambridge City Council and South Cambridgeshire District Council.

When you contact us, we will do our very best to help you. Please note our colleagues have the right to be treated with respect while they try to help you, threatening behaviour or verbal abuse will not be tolerated. We reserve the right to terminate contact if these guidelines are not followed.

## Disclaimer

The information contained in this communication from the sender is confidential. It is intended solely for use by the recipient and others authorized to receive it. If you are not the recipient, you are hereby notified that any disclosure, copying, distribution or taking action in relation of the contents of this information is strictly prohibited and may be unlawful.

This email has been scanned for viruses and malware, and may have been automatically archived