

- NOTES**
- DO NOT SCALE FROM THIS DRAWING.
 - ALL DIMENSIONS ARE IN METRES UNLESS OTHERWISE STATED.
 - LIMITS OF WORK ARE APPROXIMATE AND ARE TO BE AGREED ON SITE WITH THE OVERSEEING ORGANISATION.
 - ANY WORK OUTSIDE THE HIGHWAY BOUNDARY NEEDS PRIOR PERMISSION FROM THE LAND OWNER.
 - HEALTH AND SAFETY:
THE CONTRACTOR SHALL BE AWARE OF ALL STATUTORY UNDERTAKERS PLANT THAT MAY BE LOCATED WITHIN THE SITE. PLANS SHOWING APPROXIMATE LOCATIONS HAVE BEEN SUPPLIED BY ASSET OWNER A SET OF CURRENT (LESS THAN 90 DAYS OLD) C2 RETURNS WILL BE PROVIDED TO THE CONTRACTOR AT THE START OF WORKS.

SAFETY, HEALTH AND ENVIRONMENTAL INFORMATION

In addition to the hazards/risks normally associated with the types of work detailed on this drawing, note the following significant residual risks (Reference shall also be made to the design hazard log).

Construction
Presence of live traffic and utilities.
Presence of tar, soil contamination, asbestos and breaking of concrete not known.

Maintenance / Cleaning
None

Use
None

Decommissioning / Demolition
None

P01	RG	PM	AC	28/06/24
First Issue				
P02	SS	ANV	AC	29/01/25
Road Humps Location Updated and Added 20mph Roundel				
P03	DM	ANV	AC	05/02/25
Lighting Column and Traffic Signal added with other Updates				
Rev	Drawn / Des	Checked	Approved	Date
Description				
Drawing Status				Suitability
FOR INFORMATION				S2

KEY

- EXISTING HIGHWAY BOUNDARY
- PROPOSED KERBLINE
- PROPOSED FLAT TOPPED EDGING
- PROPOSED ROAD MARKINGS
- PROPOSED SHARED USE PATH
- PROPOSED FOOTWAY
- PROPOSED FOOTWAY ROOT PROTECTION AREA
- PROPOSED VERGE
- PROPOSED ISLAND
- PROPOSED RAISED TABLE TOP JUNCTION
- PROPOSED TACTILE PAVING (BUFF COLOUR)
- PROPOSED CONTROLLED TACTILE PAVING (RED COLOUR)
- PROPOSED CORDUROY HAZARD PAVING (BUFF COLOUR)
- PROPOSED LADDER / TRAMLINE PAVING (BUFF COLOUR)
- PROPOSED / RELOCATED TRAFFIC SIGNS
- PROPOSED ENSIGN BOLLARD
- PROPOSED TIMBER BOLLARD
- PROPOSED CIRCULAR BOLLARD
- PROPOSED DIRECTIONAL BOLLARD
- RELOCATED STREET NAMEPLATE
- PROPOSED BELISHA BEACON
- PROPOSED LIGHTING COLUMN
- PROPOSED TRAFFIC SIGNAL
- PROPOSED GUARD RAIL
- PROPOSED FLAT TOP HUMP
- PROPOSED RAMP
- SITE EXTENTS

THIS MAP IS REPRODUCED FROM ORDNANCE SURVEY MATERIAL WITH THE PERMISSION OF ORDNANCE SURVEY ON BEHALF OF THE CONTROLLER OF HIS MAJESTY'S STATIONERY OFFICE. © CROWN COPYRIGHT. UNAUTHORISED REPRODUCTION INFRINGES CROWN COPYRIGHT AND MAY LEAD TO PROSECUTION OR CIVIL PROCEEDINGS. License No. 1000 23055

FOR CONTINUATION SEE LAYOUT NO. 5228275-ATK-HGN-MELB-DR-CH-000002

AtkinsRéalis
5 Wellbrook Court, Cambridge CB3 0NA
Tel: +44 (0) 1223276002
www.atkinsrealis.com

Copyright © AtkinsRéalis (2025)

Client: **GREATER CAMBRIDGE PARTNERSHIP**
Growing and sharing prosperity
Delivering our City Deal

Project Title: **Melbourn Greenway Detailed Design**

Drawing Title: **HIGHWAYS LAYOUT PLAN MELBOURN (SCHEME 6) (SHEET 1 OF 4)**

Scale	Designed / Drawn	Checked	Approved	Authorised
1:1000	DM	ANV	AC	---
Original Size	Date	Date	Date	Date
A1	05/02/25	05/02/25	05/02/25	---
Drawing Number	Project	Originator	Volume	Job No.
5228275	5228275	ATK	HGN	MELB
DR	CH	000001	000001	5228275
Location	Type	Role	Number	Revision
				P03

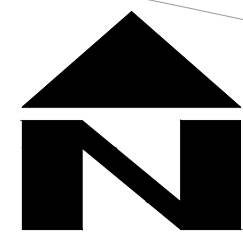

FOR CONTINUATION SEE LAYOUT NO. 5228275-ATK-HGN-MELB-DR-CH-000001

FOR CONTINUATION SEE LAYOUT NO. 5228275-ATK-HGN-MELB-DR-CH-000003

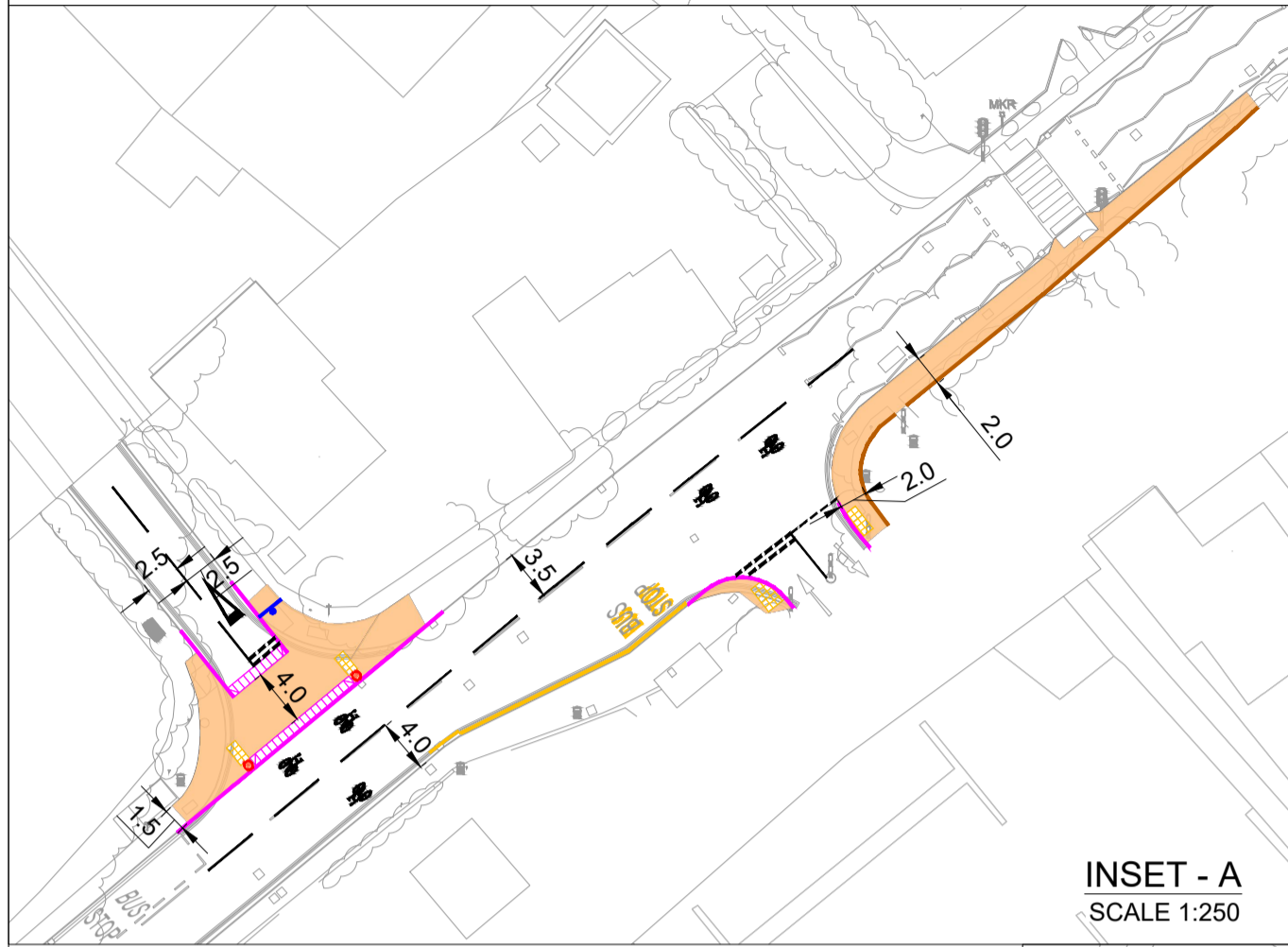

INSET - A
SCALE 1:250

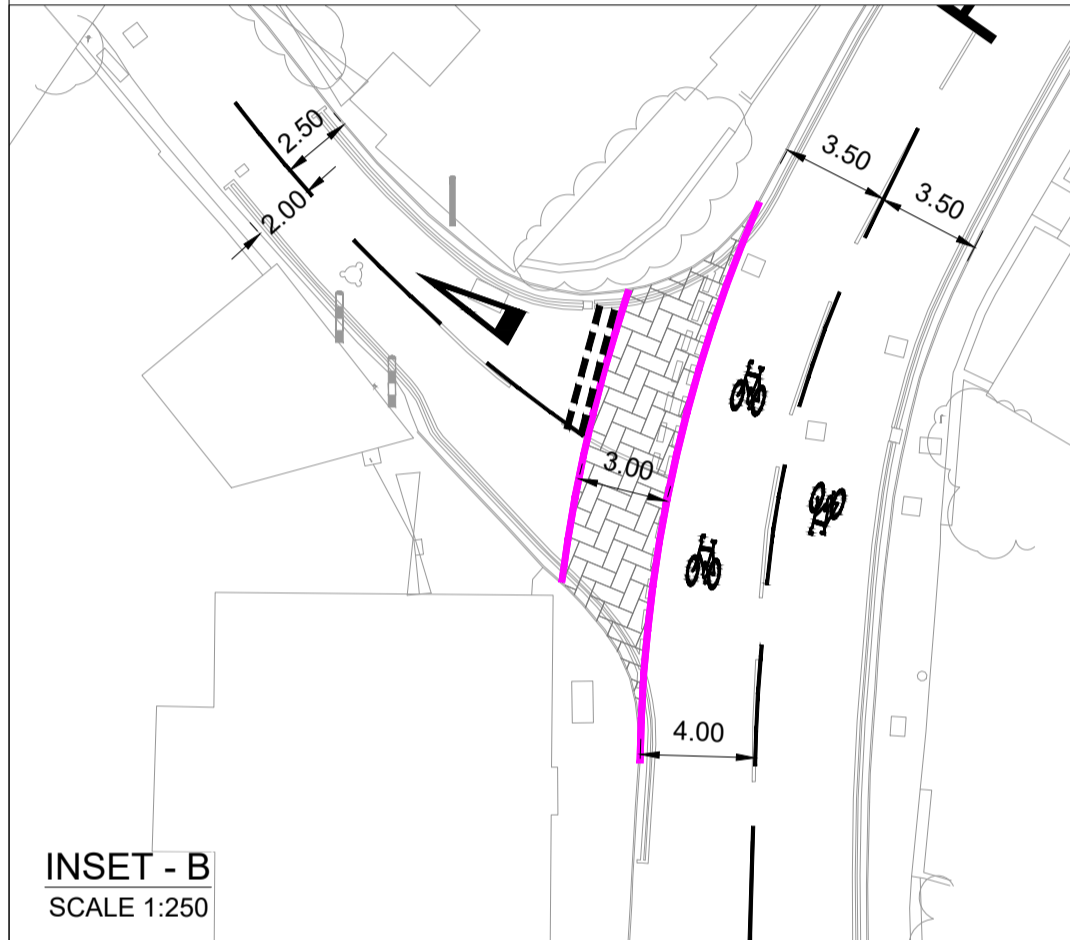

INSET - B
SCALE 1:250

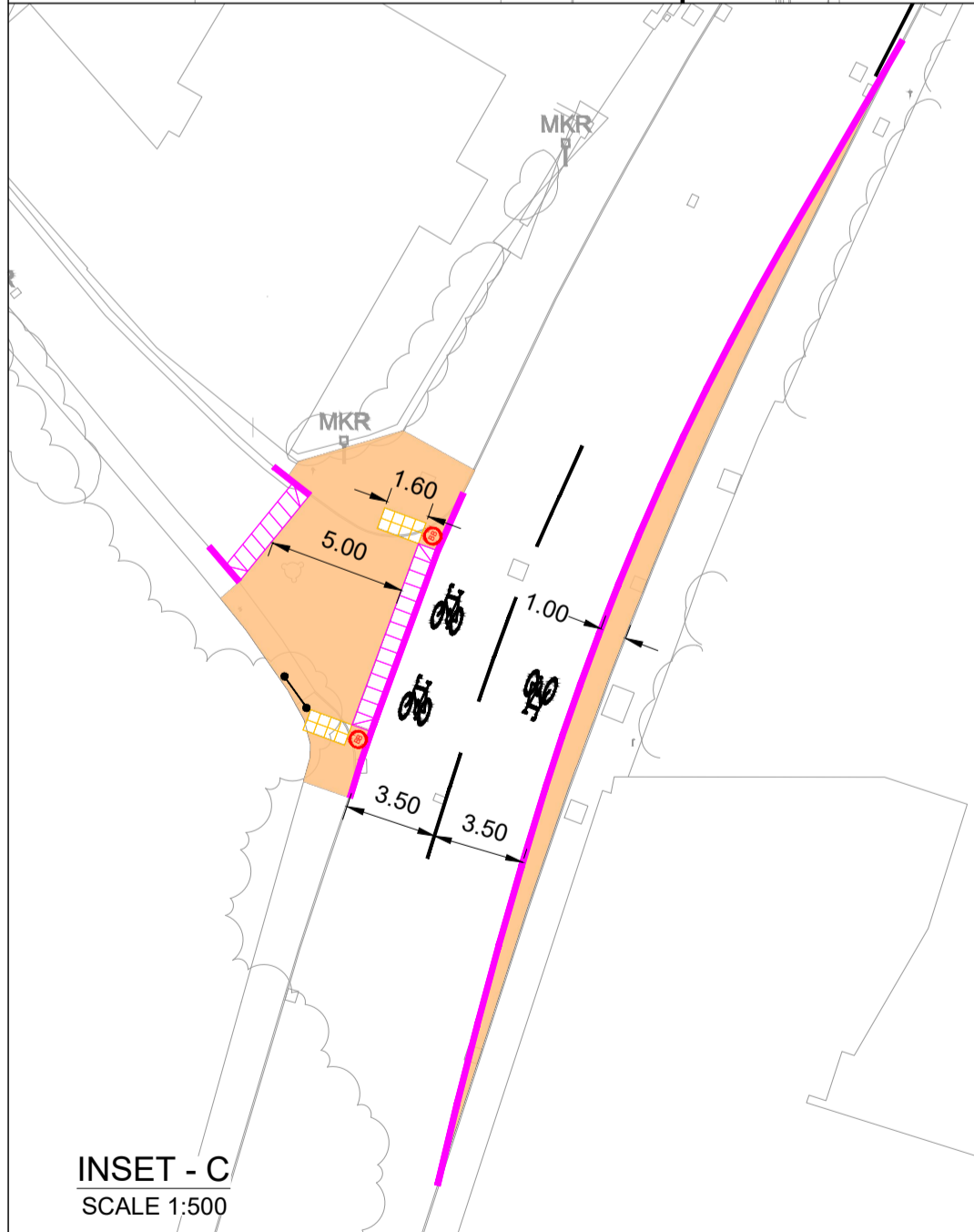

INSET - C
SCALE 1:500

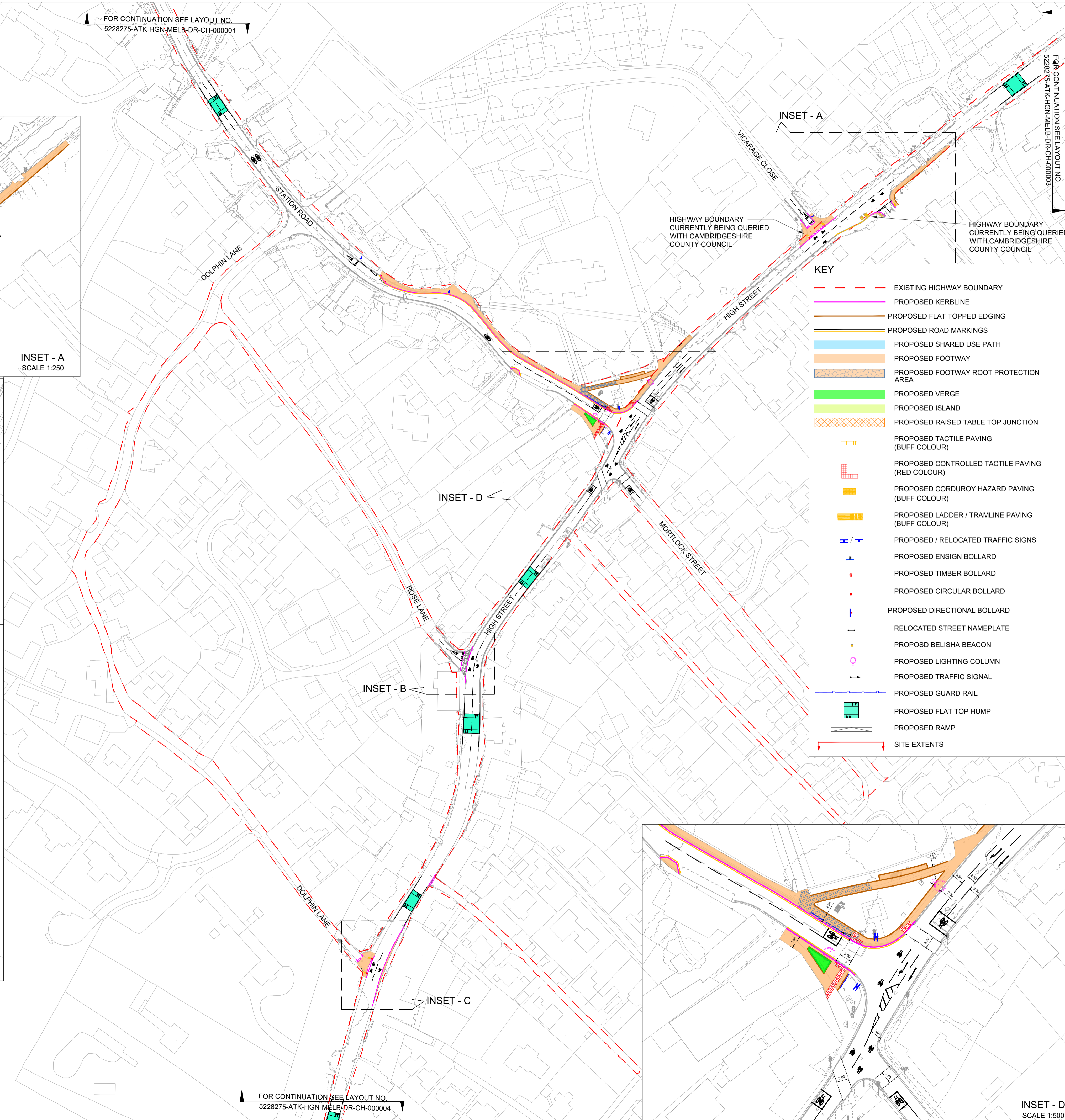

KEY

- EXISTING HIGHWAY BOUNDARY
- PROPOSED KERBLINE
- PROPOSED FLAT TOPPED EDGING
- PROPOSED ROAD MARKINGS
- PROPOSED SHARED USE PATH
- PROPOSED FOOTWAY
- PROPOSED FOOTWAY ROOT PROTECTION AREA
- PROPOSED VERGE
- PROPOSED ISLAND
- PROPOSED RAISED TABLE TOP JUNCTION
- PROPOSED TACTILE PAVING (BUFF COLOUR)
- PROPOSED CONTROLLED TACTILE PAVING (RED COLOUR)
- PROPOSED CORDUROY HAZARD PAVING (BUFF COLOUR)
- PROPOSED LADDER / TRAMLINE PAVING (BUFF COLOUR)
- PROPOSED / RELOCATED TRAFFIC SIGNS
- PROPOSED ENSIGN BOLLARD
- PROPOSED TIMBER BOLLARD
- PROPOSED CIRCULAR BOLLARD
- PROPOSED DIRECTIONAL BOLLARD
- RELOCATED STREET NAMEPLATE
- PROPOSED BELISHA BEACON
- PROPOSED LIGHTING COLUMN
- PROPOSED TRAFFIC SIGNAL
- PROPOSED GUARD RAIL
- PROPOSED FLAT TOP HUMPS
- PROPOSED RAMP
- SITE EXTENTS

- NOTES**
- DO NOT SCALE FROM THIS DRAWING.
 - ALL DIMENSIONS ARE IN METRES UNLESS OTHERWISE STATED.
 - LIMITS OF WORK ARE APPROXIMATE AND ARE TO BE AGREED ON SITE WITH THE OVERSEEING ORGANISATION.
 - ANY WORK OUTSIDE THE HIGHWAY BOUNDARY NEEDS PRIOR PERMISSION FROM THE LAND OWNER.
 - HEALTH AND SAFETY: THE CONTRACTOR SHALL BE AWARE OF ALL STATUTORY UNDERTAKERS PLANT THAT MAY BE LOCATED WITHIN THE SITE. PLANS SHOWING APPROXIMATE LOCATIONS HAVE BEEN SUPPLIED BY ASSET OWNER. A SET OF CURRENT (LESS THAN 90 DAYS OLD) C2 RETURNS WILL BE PROVIDED TO THE CONTRACTOR AT THE START OF WORKS.

SAFETY, HEALTH AND ENVIRONMENTAL INFORMATION

In addition to the hazards/risks normally associated with the types of work detailed on this drawing, note the following significant residual risks (Reference shall also be made to the design hazard log).

Construction
Presence of live traffic and utilities.
Presence of tar, soil contamination, asbestos and breaking of concrete not known.

Maintenance / Cleaning
None

Use
None

Decommissioning / Demolition
None

P01	RG	PM	AC	28/06/24
-----	----	----	----	----------

First Issue
P02 SS ANV AC 29/01/25

Road Humps Location Updated and Added 20mph Roundel
P03 DM ANV AC 05/02/25

Lighting Column and Traffic Signal added with other Updates

Rev	Drawn / Des	Checked	Approved	Date
-----	-------------	---------	----------	------

Description

Drawing Status	FOR INFORMATION	Suitability	S2
----------------	-----------------	-------------	----

AtkinsRéalis
5 Wellbrook Court, Cambridge CB3 0NA

Tel: +44 (0) 122376002
www.atkinsrealis.com

Copyright © AtkinsRéalis (2025)



Project Title
Melbourn Greenway Detailed Design

Drawing Title
HIGHWAYS LAYOUT PLAN MELBOURN (SHEET 6) (SHEET 2 OF 4)

Scale	Designed / Drawn	Checked	Approved	Authorised
1:1000	DM	ANV	AC	---
Original Size	Date	Date	Date	Date
A1	05/02/25	05/02/25	05/02/25	---

Drawing Number	Project	Originator	Volume	Job No.
5228275	ATK HGN MELB	DR CH	000002	5228275
Location	Type	Role	Number	Revision
				P03

THIS MAP IS REPRODUCED FROM ORDNANCE SURVEY MATERIAL WITH THE PERMISSION OF ORDNANCE SURVEY ON BEHALF OF THE CONTROLLER OF HIS MAJESTY'S STATIONERY OFFICE. © CROWN COPYRIGHT. UNAUTHORISED REPRODUCTION INFRINGES CROWN COPYRIGHT AND MAY LEAD TO PROSECUTION OR CIVIL PROCEEDINGS. License No: 1000 23025

FOR CONTINUATION SEE LAYOUT NO. 5228275-ATK-HGN-MELB-DR-CH-000004

INSET - D
SCALE 1:500

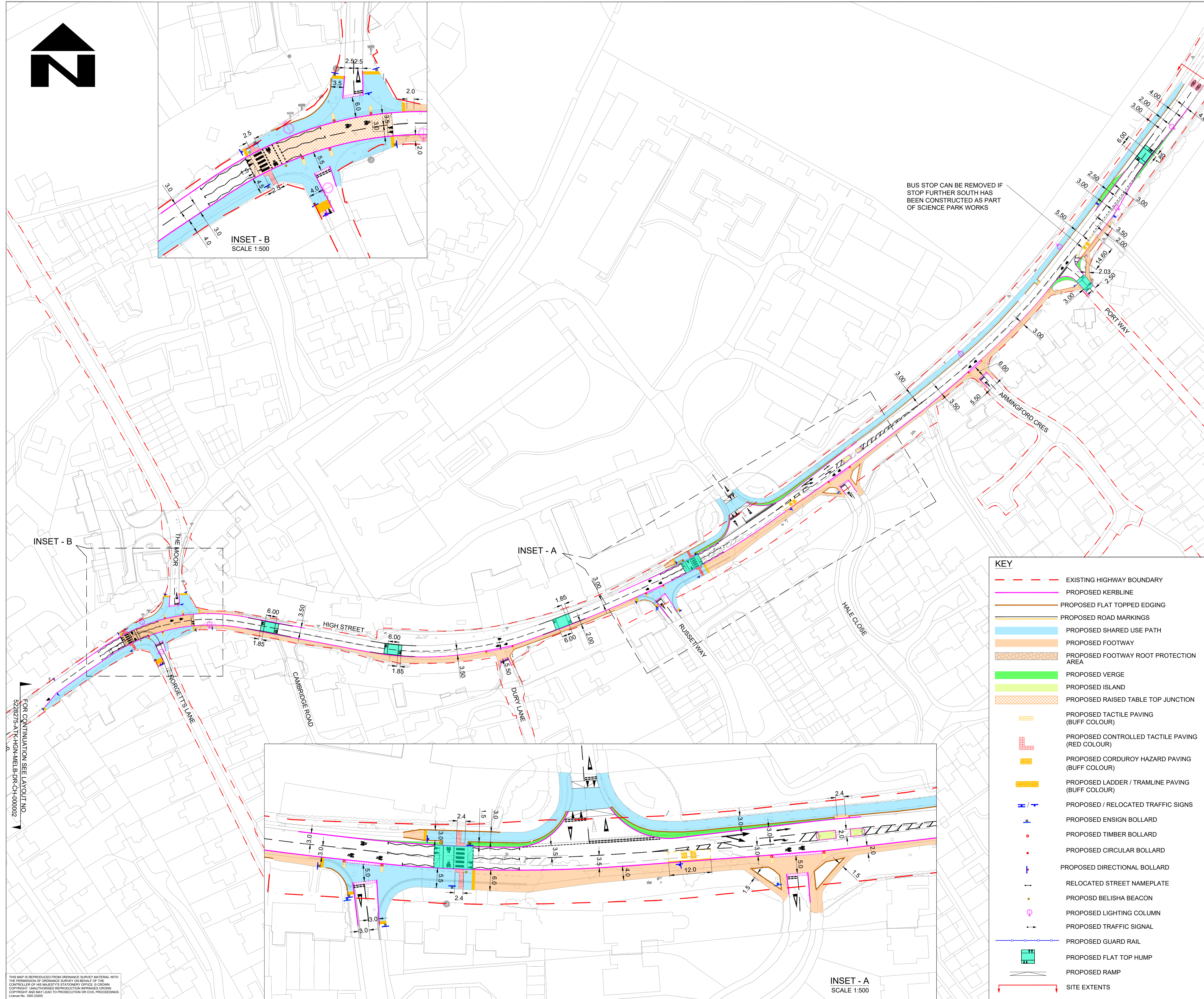
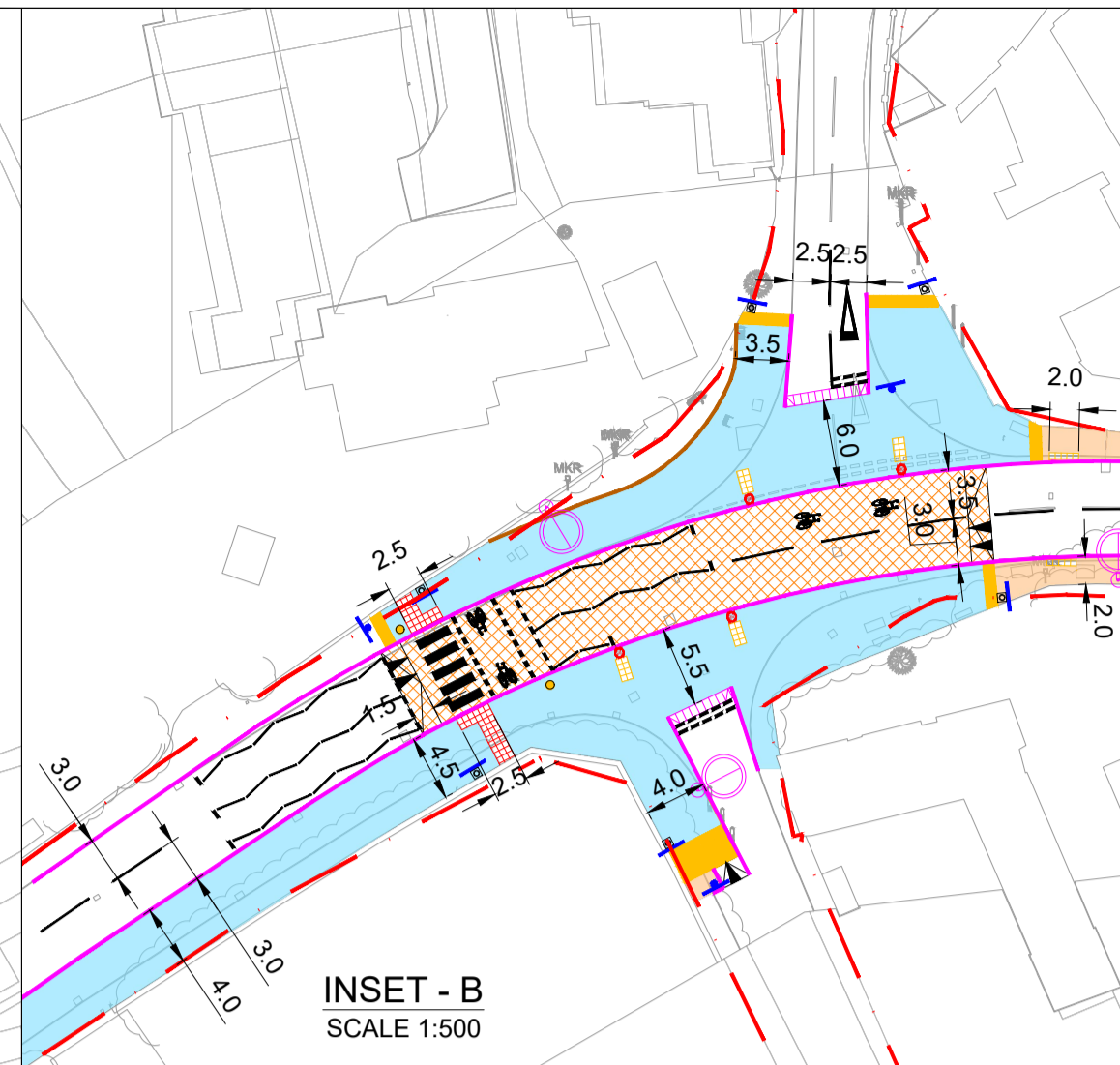
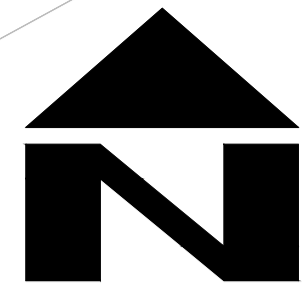

BUS STOP CAN BE REMOVED IF STOP FURTHER SOUTH HAS BEEN CONSTRUCTED AS PART OF SCIENCE PARK WORKS

KEY

- EXISTING HIGHWAY BOUNDARY
- PROPOSED KERBLINE
- PROPOSED FLAT TOPPED EDGING
- PROPOSED ROAD MARKINGS
- PROPOSED SHARED USE PATH
- PROPOSED FOOTWAY
- PROPOSED FOOTWAY ROOT PROTECTION AREA
- PROPOSED VERGE
- PROPOSED ISLAND
- PROPOSED RAISED TABLE TOP JUNCTION
- PROPOSED TACTILE PAVING (BUFF COLOUR)
- PROPOSED CONTROLLED TACTILE PAVING (RED COLOUR)
- PROPOSED CORDUROY HAZARD PAVING (BUFF COLOUR)
- PROPOSED LADDER / TRAMLINE PAVING (BUFF COLOUR)
- PROPOSED / RELOCATED TRAFFIC SIGNS
- PROPOSED ENSIGN BOLLARD
- PROPOSED TIMBER BOLLARD
- PROPOSED CIRCULAR BOLLARD
- PROPOSED DIRECTIONAL BOLLARD
- RELOCATED STREET NAMEPLATE
- PROPOSED BELISHA BEACON
- PROPOSED LIGHTING COLUMN
- PROPOSED TRAFFIC SIGNAL
- PROPOSED GUARD RAIL
- PROPOSED FLAT TOP HUMPS
- PROPOSED RAMP
- SITE EXTENTS

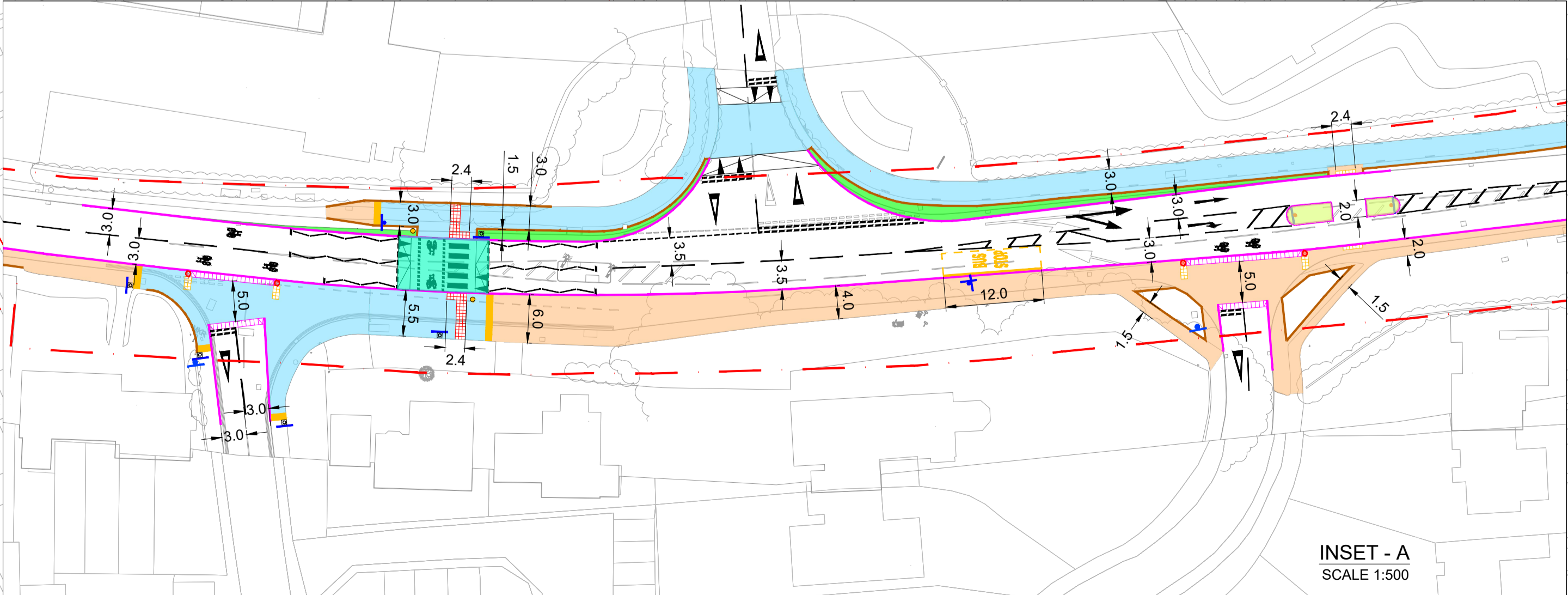

- NOTES**
- DO NOT SCALE FROM THIS DRAWING.
 - ALL DIMENSIONS ARE IN METRES UNLESS OTHERWISE STATED.
 - LIMITS OF WORK ARE APPROXIMATE AND ARE TO BE AGREED ON SITE WITH THE OVERSEEING ORGANISATION.
 - ANY WORK OUTSIDE THE HIGHWAY BOUNDARY NEEDS PRIOR PERMISSION FROM THE LAND OWNER.
 - HEALTH AND SAFETY: THE CONTRACTOR SHALL BE AWARE OF ALL STATUTORY UNDERTAKERS PLANT THAT MAY BE LOCATED WITHIN THE SITE. PLANS SHOWING APPROXIMATE LOCATIONS HAVE BEEN SUPPLIED BY ASSET OWNER. A SET OF CURRENT (LESS THAN 90 DAYS OLD) C2 RETURNS WILL BE PROVIDED TO THE CONTRACTOR AT THE START OF WORKS.

SAFETY, HEALTH AND ENVIRONMENTAL INFORMATION

In addition to the hazards/risks normally associated with the types of work detailed on this drawing, note the following significant risks (Reference shall also be made to the design hazard log).

Construction	Presence of live traffic and utilities.
Maintenance / Cleaning	Presence of tar, soil contamination, asbestos and breaking of concrete not known.
Use	None
Decommissioning / Demolition	None

P01	RG	PM	AC	28/06/24
First Issue				
P02	SS	ANV	AC	29/01/25
Road Humps Location Updated and Added 20mph Roundel				
P03	DM	ANV	AC	05/02/25
Lighting Column and Traffic Signal added with other Updates				
Rev	Drawn / Des	Checked	Approved	Date
Description				

Drawing Status	Suitability
FOR INFORMATION	S2

AtkinsRéalis
5 Wellbrook Court, Cambridge CB3 0NA
Tel: +44 (0) 1223276002
www.atkinsrealis.com

Copyright © AtkinsRéalis (2025)
Client: **GREATER CAMBRIDGE PARTNERSHIP**
Growing and sharing prosperity
Delivering our City Deal

Project Title: **Melbourn Greenway Detailed Design**

Drawing Title: HIGHWAYS LAYOUT PLAN MELBOURN (SCHEME 6) (SHEET 3 OF 4)				
Scale: 1:1000	Designed / Drawn: DM	Checked: ANV	Approved: AC	Authorised: ---
Original Size: A1	Date: 05/02/25	Date: 05/02/25	Date: 05/02/25	Date: ---
Drawing Number: 5228275	Project: ATK	Originator: HGN	Volume: MELB	Job No.: 5228275
Location: DR	Type: CH	Role: 000003	Number: P03	Revision: ---

THIS MAP IS REPRODUCED FROM ORDNANCE SURVEY MATERIAL WITH THE PERMISSION OF ORDNANCE SURVEY ON BEHALF OF THE CONTROLLER OF HIS MAJESTY'S STATIONERY OFFICE. © CROWN COPYRIGHT. UNAUTHORISED REPRODUCTION INFRINGES CROWN COPYRIGHT AND MAY LEAD TO PROSECUTION OR CIVIL PROCEEDINGS. License No: 1000 23055
CAD FILE: C:\projectwise\atkins_transportation_uk\id0439168\5228275-ATK-HGN-MELB-DR-CH-000003.dwg

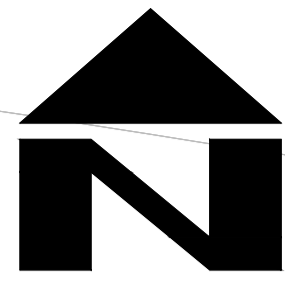

FOR CONTINUATION SEE LAYOUT NO. 5228275-ATK-HGN-MELB-DR-CH-000002

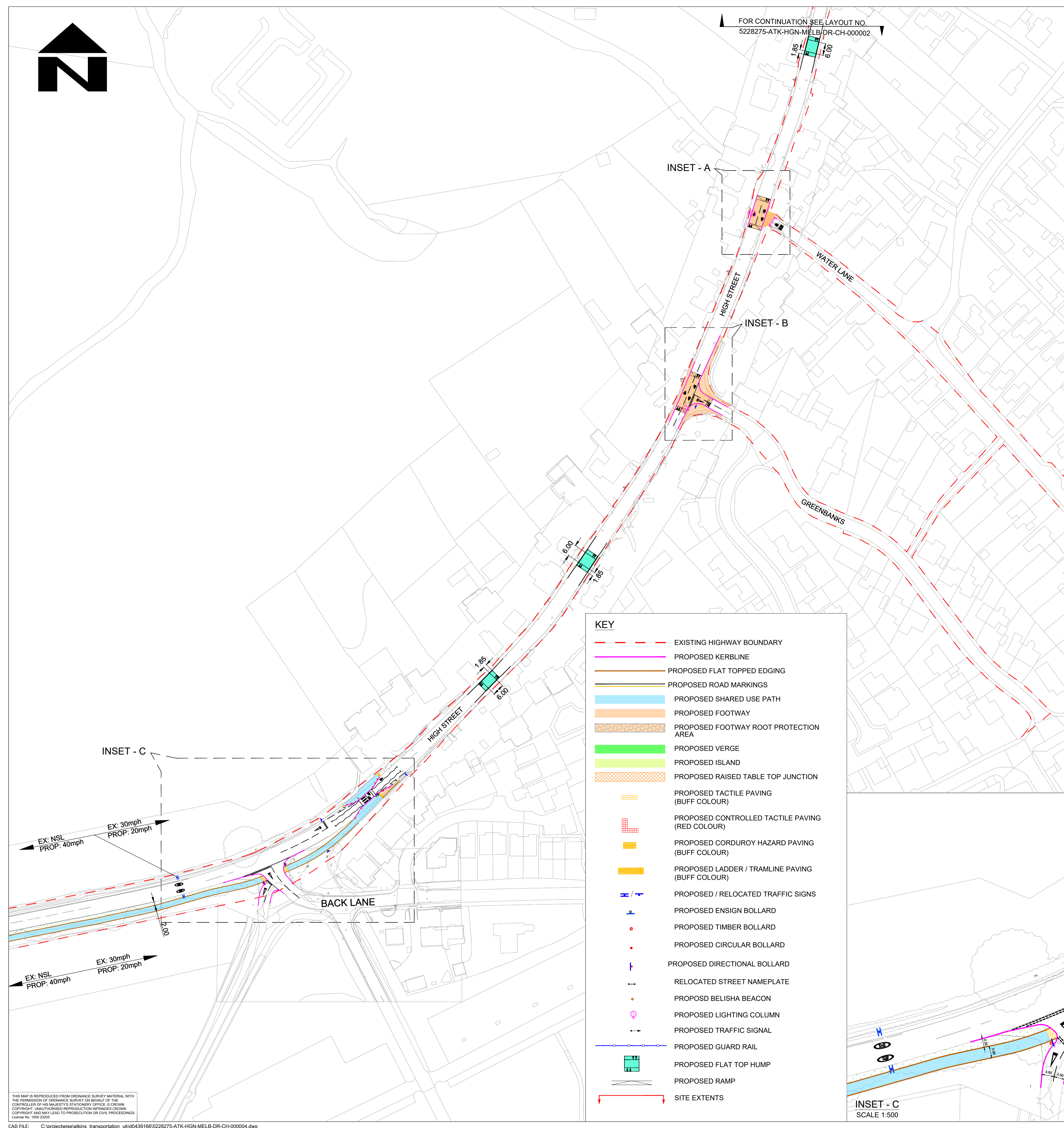

INSET - A

INSET - B

INSET - C

KEY

- EXISTING HIGHWAY BOUNDARY
- PROPOSED KERBLINE
- PROPOSED FLAT TOPPED EDGING
- PROPOSED ROAD MARKINGS
- PROPOSED SHARED USE PATH
- PROPOSED FOOTWAY
- PROPOSED FOOTWAY ROOT PROTECTION AREA
- PROPOSED VERGE
- PROPOSED ISLAND
- PROPOSED RAISED TABLE TOP JUNCTION
- PROPOSED TACTILE PAVING (BUFF COLOUR)
- PROPOSED CONTROLLED TACTILE PAVING (RED COLOUR)
- PROPOSED CORDUROY HAZARD PAVING (BUFF COLOUR)
- PROPOSED LADDER / TRAMLINE PAVING (BUFF COLOUR)
- PROPOSED / RELOCATED TRAFFIC SIGNS
- PROPOSED ENSIGN BOLLARD
- PROPOSED TIMBER BOLLARD
- PROPOSED CIRCULAR BOLLARD
- PROPOSED DIRECTIONAL BOLLARD
- RELOCATED STREET NAMEPLATE
- PROPOSED BELISHA BEACON
- PROPOSED LIGHTING COLUMN
- PROPOSED TRAFFIC SIGNAL
- PROPOSED GUARD RAIL
- PROPOSED FLAT TOP HUMPS
- PROPOSED RAMP
- SITE EXTENTS

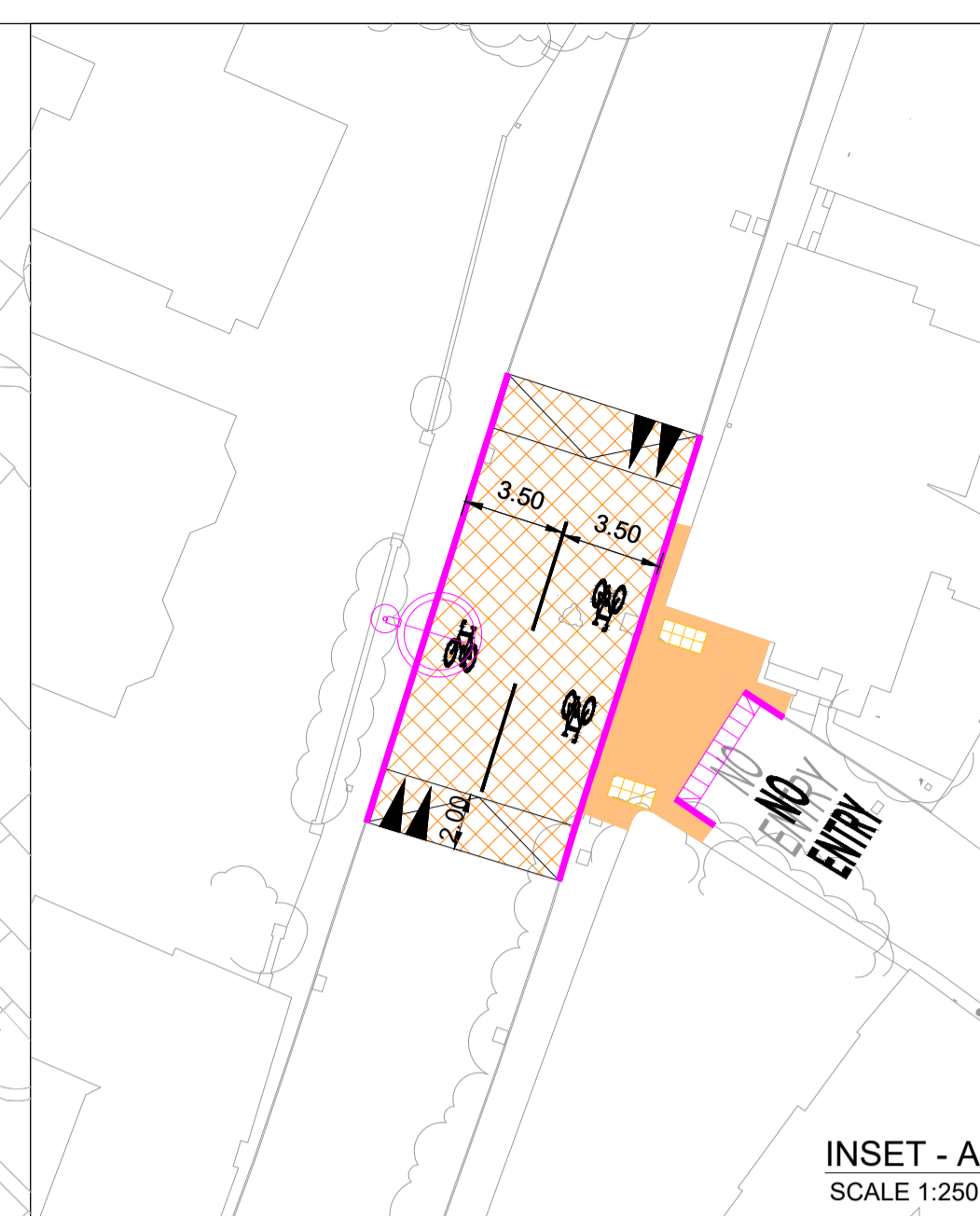

INSET - A SCALE 1:250

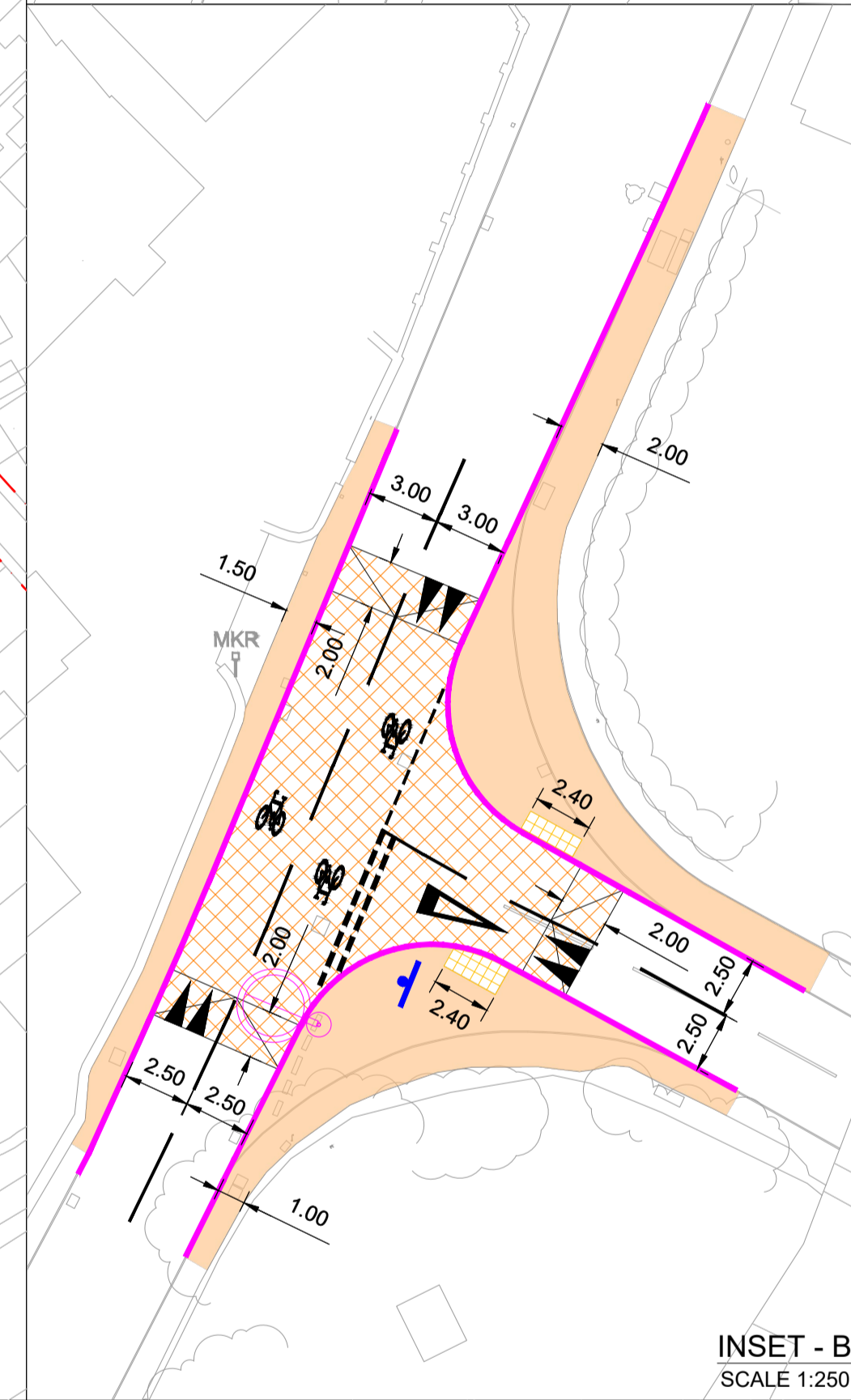

INSET - B SCALE 1:250

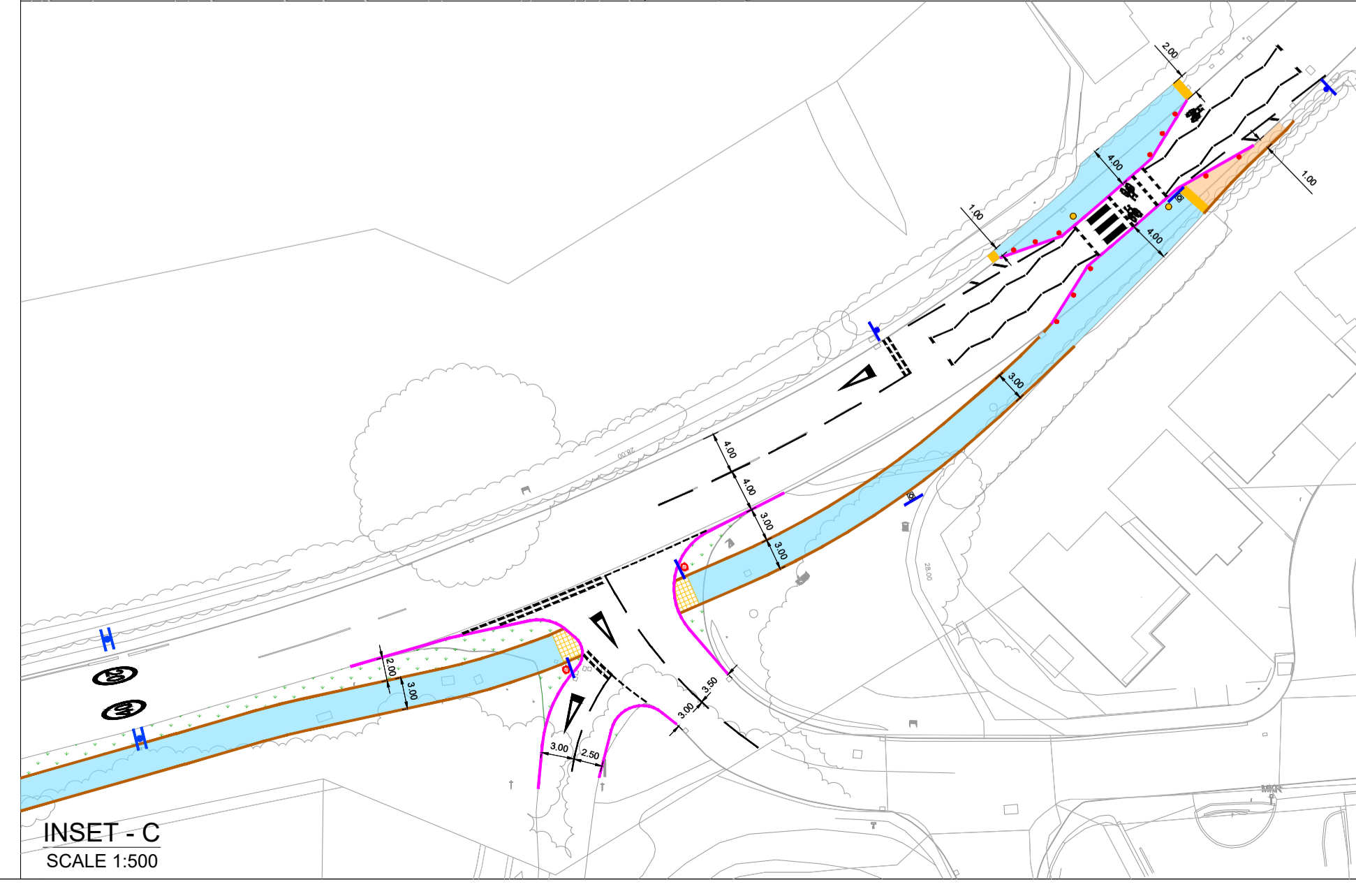

INSET - C SCALE 1:500

- NOTES**
- DO NOT SCALE FROM THIS DRAWING.
 - ALL DIMENSIONS ARE IN METRES UNLESS OTHERWISE STATED.
 - LIMITS OF WORK ARE APPROXIMATE AND ARE TO BE AGREED ON SITE WITH THE OVERSEEING ORGANISATION.
 - ANY WORK OUTSIDE THE HIGHWAY BOUNDARY NEEDS PRIOR PERMISSION FROM THE LAND OWNER.
 - HEALTH AND SAFETY: THE CONTRACTOR SHALL BE AWARE OF ALL STATUTORY UNDERTAKERS PLANT THAT MAY BE LOCATED WITHIN THE SITE. PLANS SHOWING APPROXIMATE LOCATIONS HAVE BEEN SUPPLIED BY ASSET OWNER. A SET OF CURRENT (LESS THAN 90 DAYS OLD) C2 RETURNS WILL BE PROVIDED TO THE CONTRACTOR AT THE START OF WORKS.

SAFETY, HEALTH AND ENVIRONMENTAL INFORMATION

In addition to the hazards/risks normally associated with the types of work detailed on this drawing, note the following significant residual risks (Reference shall also be made to the design hazard log).

Construction
Presence of live traffic and utilities.
Presence of tar, soil contamination, asbestos and breaking of concrete not known.

Maintenance / Cleaning
None

Use
None

Decommissioning / Demolition
None

P01	RG	PM	AC	28/06/24
-----	----	----	----	----------

First Issue

P02	SS	ANV	AC	29/01/25
-----	----	-----	----	----------

Road Humps Location Updated and Added 20mph Roundel

P03	DM	ANV	AC	05/02/25
-----	----	-----	----	----------

Lighting Column and Traffic Signal added with other Updates

Rev	Drawn / Des	Checked	Approved	Date
Description				

FOR INFORMATION



5 Wellbrook Court, Cambridge CB3 0NA
Tel: +44 (0) 1223276002
www.atkinsrealis.com

Copyright © AtkinsRéalis (2025)



Project Title
Melbourn Greenway Detailed Design

Drawing Title
HIGHWAYS LAYOUT PLAN MELBOURN (SCHEME 6) (SHEET 4 OF 4)

Scale	Designed / Drawn	Checked	Approved	Authorised
1:1000	DM	ANV	AC	---
Original Size	Date	Date	Date	Date
A1	05/02/25	05/02/25	05/02/25	---
Drawing Number	Project	Originator	Volume	Job No.
5228275	DR	ATK CH	HGN MELB 000004	5228275
Location	Type	Role	Number	Revision
				P03

THIS MAP IS REPRODUCED FROM ORDNANCE SURVEY MATERIAL WITH THE PERMISSION OF ORDNANCE SURVEY ON BEHALF OF THE CONTROLLER OF HIS MAJESTY'S STATIONERY OFFICE. © CROWN COPYRIGHT. UNAUTHORISED REPRODUCTION INFRINGES CROWN COPYRIGHT AND MAY LEAD TO PROSECUTION OR CIVIL PROCEEDINGS. License No. 1000 23055