

Public

My ref: PCL/BST9480/PKG-AJ/SM

Your ref:

Date: 7<sup>th</sup> February 2024

Contact E Mail: TrafficOrders@ProjectCentre.co.uk



**Frank Jordan**  
Executive Director  
Place and Sustainability  
Highways Maintenance

**By email only:**

parishclerk@melbournparishcouncil.gov.uk  
Melbourn Parish Council  
30 High St  
Melbourn  
Royston  
SG8 6DZ

**Box STA2101**  
Huntingdon Highways Depot  
Stanton Way  
Huntingdon  
PE29 6PY

Dear Sirs

**Cambridgeshire County Council – Meldreth Link Bridleway  
Public Path Creation Agreement 2024**

Cambridgeshire County Council has received an application from the Greater Cambridge Partnership to upgrade part of the existing Public Footpath Meldreth 160/9 to that of a Bridleway between a point just north of the A10 underpass and Meldreth railway station. The proposal is made under Sections 25 and 29 of the Highways Act 1980.

This new bridleway is being provided as part of the Cambridge Greenways programme of access improvements for non-motorised traffic. The Cambridge Greenways are funded by City Deal to support economic growth and are delivered by the Greater Cambridge Partnership.

Please find attached a plan which details the location and proposed alignment of the route. The route of Public Footpath Meldreth 160/9 currently recorded on the Definitive Map and Statement runs between Station Road and High Street, Meldreth. The proposed Creation Agreement is to upgrade that length of Public Footpath Meldreth 160/9 that runs between runs between points "A" and "C" on the plan to that of a Bridleway.

The proposed alignment of the Bridleway will be approximately 4.5 metres in width made up of a 3 metre paved / asphalt surfaced path abutting a 1.5 metre verge and drainage feature buffer. Two 4.2 metre wide metal gates will be sited on either side of the Bridleway at point "B" to allow the land owner access to safely cross farm vehicles or other agricultural plant between fields as and when required. The gates will fold back to the landowners' boundary when opened, secured at that position and not left deliberately or accidentally across the Public Right of Way.

I would be grateful to receive any comments that you wish to make on the proposal by Wednesday 6<sup>th</sup> March 2024.

Please do not hesitate to get in touch should you have any questions or wish to discuss this matter further.

Yours faithfully

**For Cambridgeshire County Council**

# Cambridgeshire County Council

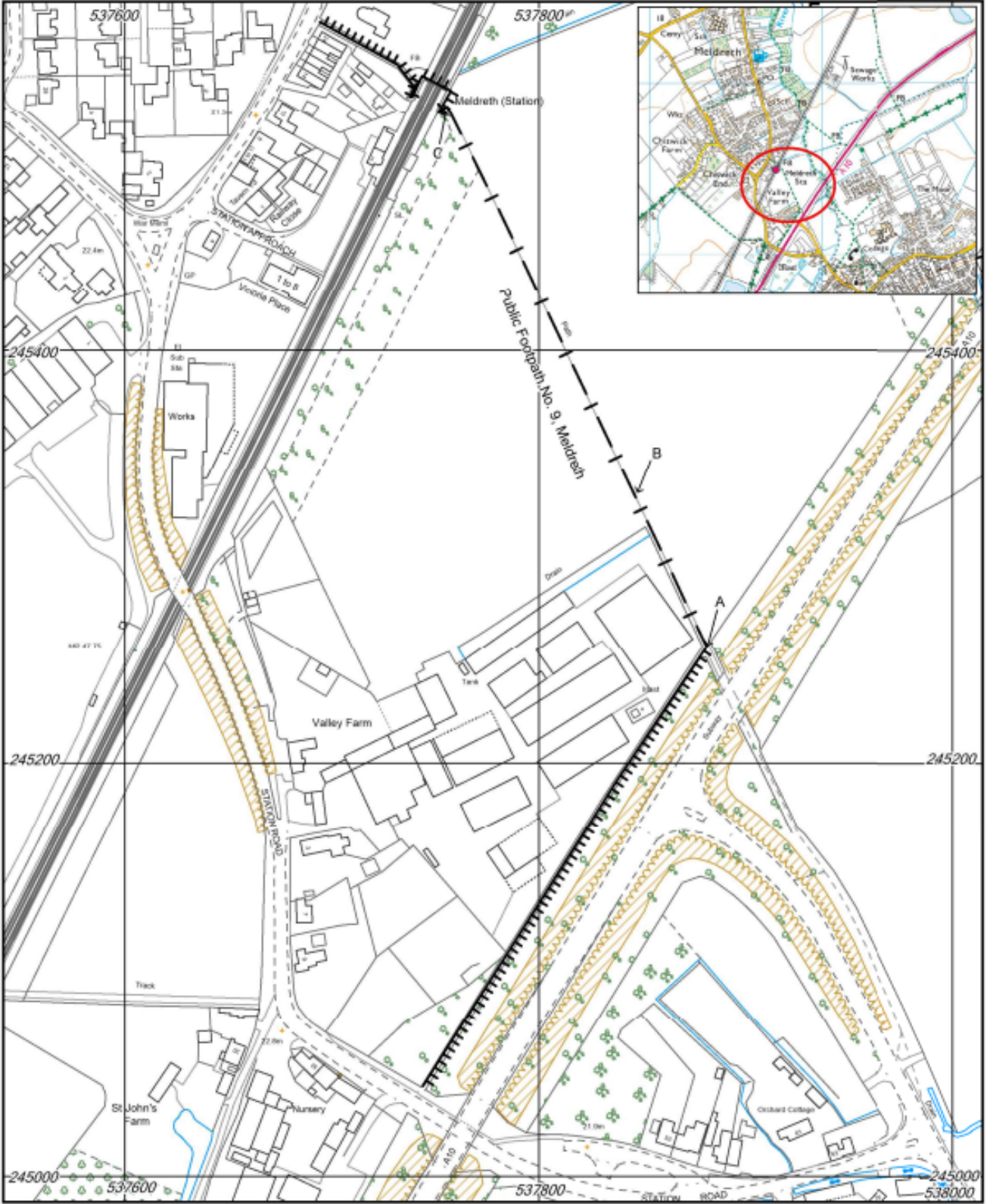

Scale: 1:2500



**THIS PLAN FORMS PART OF THE CAMBRIDGESHIRE COUNTY COUNCIL  
(MELDRETH LINK BRIDLEWAY) PUBLIC PATH CREATION AGREEMENT 2024**

Unaffected Public Footpath		Public Footpath to be upgraded to a Public Bridleway (A-B-C)

© Crown copyright and database rights 2024 OS AC0000822131