

Reference: 77 Victoria Way

██
77 Victoria Way
Melbourn

13 April 2023

To whom it might concern

Dear local council, we are writing to you regarding the front garden of our property, No. 77 Victoria Way, Melbourn, SG8 6FE.

As you are aware most of the land at the front of 77 Victoria Way belongs to the local parish council and not to us, see copy of deeds attached. We would like to explore the possibility of purchasing all or some of this land to ease traffic and parking constraints while also ensuring suitable maintenance of the otherwise abandoned piece of land.

The flow of traffic to the cemetery entrance is of critical importance and parking around Victoria Way is becoming a major issue. The situation is sometimes dire as, on occasions, there are barely any spaces available through the whole of the development. The privately owned access road to the cemetery is poorly designed, with the cemetery ground maintenance team requiring to mount our drive to get their vehicles through the cemetery gate. Indeed, the road is so poorly designed that for any of the residents to turn their car around we must either enter the cemetery car park or reverse out of the road which has caused many problems for the cemetery visitors. Therefore, we would like to enquire about purchasing the land at the front of our property from the parish council. We propose a sufficient design could be agreed to allow suitable additional parking to alleviate some of the congestion issues while, most importantly, leaving the full road width access to the cemetery gate at a critical juncture.

Furthermore, there is currently insufficient maintenance of the otherwise abandoned land. To the best of our knowledge there has been no maintenance of that land since we moved into the property in June 2019. Instead, as proud homeowners and keen community members, we have provided the maintenance ourselves, including weeding, trimming of the bushes and planting of bulbs in keeping with those of the cemetery. In addition, we have been removing rubbish on the land from the cemetery, both deposited by visitors and after winds and rains have blown it from the cemetery. More worryingly is the need to remove dog excrement from the front of the house left by visitors to the cemetery. However, to date we have limited our activities to the very basics as the land does not belong to us and as you can understand this minimal maintenance work is not sustainable in the long term.

Our proposal is to work with you and reach an agreement on how the aesthetics of the land would work and so all parties are happy with any proposed landscape changes. We are fully committed to ensuring that any changes made, or maintenance given, is in keeping with the current landscape of the cemetery, and for the benefit of all visitors.

Please advise on the best possible course of action in addressing the issues raised here.

██

██

These are the notes referred to on the following official copy

The electronic official copy of the title plan follows this message.

Please note that this is the only official copy we will issue. We will not issue a paper official copy.

This official copy was delivered electronically and when printed will not be to scale. You can obtain a paper official copy by ordering one from HM Land Registry.

This official copy is issued on 13 May 2022 shows the state of this title plan on 13 May 2022 at 11:35:01. It is admissible in evidence to the same extent as the original (s.67 Land Registration Act 2002). This title plan shows the general position, not the exact line, of the boundaries. It may be subject to distortions in scale. Measurements scaled from this plan may not match measurements between the same points on the ground. This title is dealt with by the HM Land Registry, Peterborough Office .

HM Land Registry
Official copy of
title plan

Title number **CB443534**
Ordnance Survey map reference **TL3843NE**
Scale **1:1250 enlarged from 1:2500**
Administrative area **Cambridgeshire : South
Cambridgeshire**

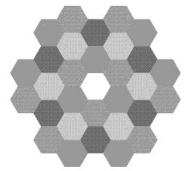

© Crown copyright and database rights 2022 Ordnance Survey 100026316. You are not permitted to copy, sub-license, distribute or sell any of this data to third parties in any form.

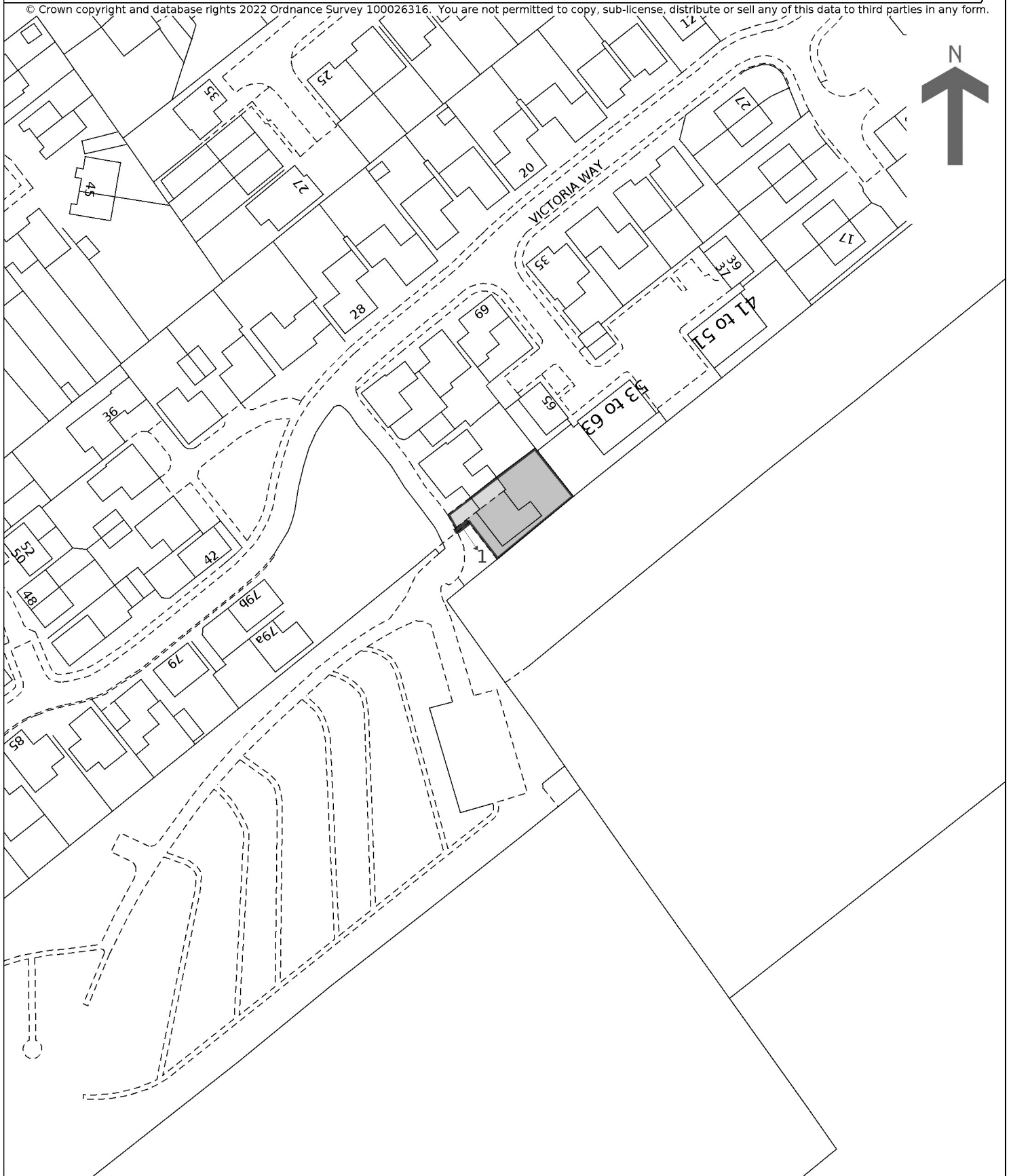

KEY
SITE BOUNDARY

